

FREE!



Chairman of the Boards BRUCE DESHANO
COO NICK DESHANO
Editor MARK ROMANACK

Volume 27, 2020



The OFF SHORE RELEASE

Your Leader In Trolling Technology www.offshoretackle.com



Printed by Pioneer Printing



Off Shore Tackle Pro Staffer Chris Souders is a catfish specialist who routinely puts monster cats like this in the boat using Off Shore Tackle planer boards.

**Tips and Techniques brought to you by
Your Leaders In Trolling Technology,
Off Shore Tackle LLC and Riviera Trolling Systems**



Volume 27, 2020



Chairman of the Boards BRUCE DESHANO
COO NICK DESHANO
Editor MARK ROMANACK

The OFF SHORE RELEASE

Your Leader In Trolling Technology www.offshoretackle.com



Printed by Pioneer Printing

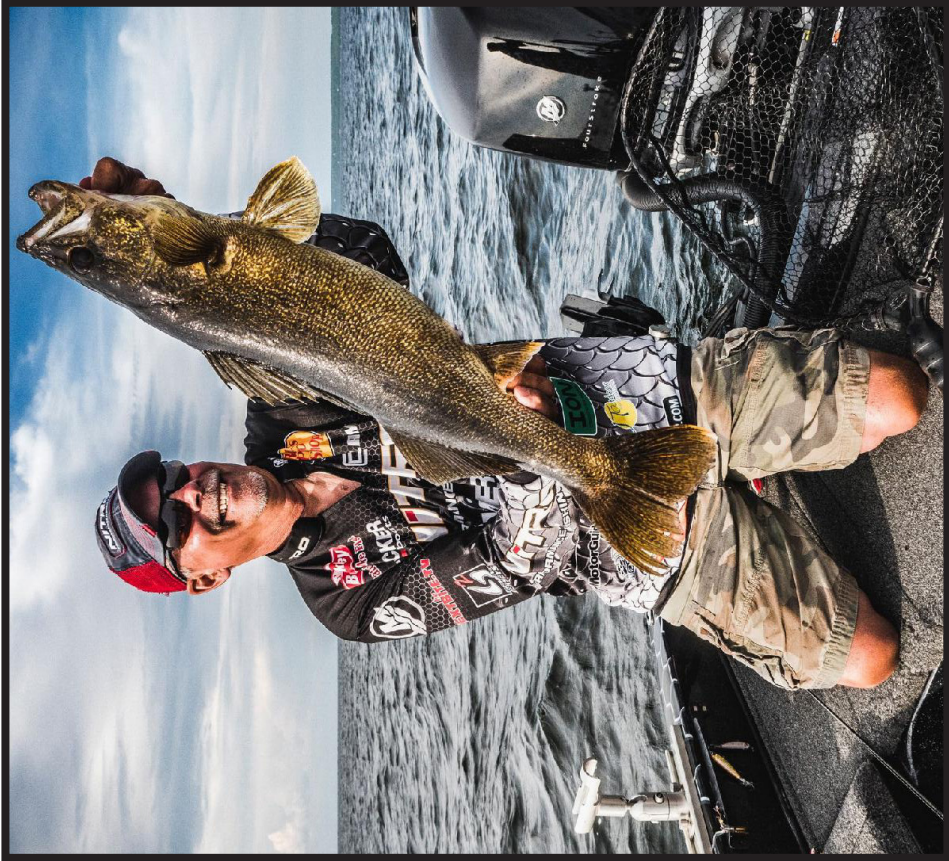

Walleye fishing legend and Hall of Fame Angler Gary Parsons knows the importance of fishing fundamentals and has achieved many victories over the years by putting those exact fundamentals to use.

**Tips and Techniques brought to you by
Your Leaders In Trolling Technology,
Off Shore Tackle LLC and Riviera Trolling Systems**

CONGRATULATIONS TO BRUCE DESHANO, FRESHWATER FISHING HALL OF FAME INDUCTEE

BY: NICK DESHANO WITH MARK ROMANACK AND STEVE WORALL

We are delighted to report that the Hayward Freshwater Fishing Hall of Fame has announced Bruce DeShano, CEO of Off Shore Tackle, will be inducted into the Hall of Fame Saturday, January 18th, 2020 at the Northern Illinois Sport Show held on the Lake County Fairgrounds!

Bruce is a lifelong resident of Michigan and has been an avid angler his entire life. He was one of the pioneers of charter fishing on Lake Huron, getting his first license in 1978. After finding success in both charter fishing and in tournaments for trout and salmon, Bruce started Off Shore Tackle. At the beginning, Off Shore Tackle was primarily producing big water trolling products like downrigger releases, stacker releases and traditional planer board clips. In the early 90’s, Bruce was interested in expanding his product line to include walleye specific products. His constant quest was and still is to design and bring to market the finest trolling products in the industry.

Bruce proved the effectiveness of many premium Off Shore Tackle Co. LLC products through competitive angling and his association with the top walleye anglers in the world. He plunged head first into the world of professional fishing by participating and sponsoring at the In-Fisherman Pro Walleye Tour (now known as the Cabela’s National Walleye Tour), the Masters Walleye Circuit and the Michigan Walleye Tour.

To get the word out, Bruce assembled an impressive list of pro anglers on the tournament trail to put the Off Shore Tackle products to the ultimate test. Surrounding himself with the most talented walleye anglers in the nation, Bruce was able to build Off Shore Tackle into an internationally distributed powerhouse

brand that lives up to their company slogan “Your Leader in Trolling Technology”. By making products like the OR12 Side Planer boards, Tattle Flags™ and weight systems like Tadpole divers, Bruce has had a major impact on the fishing industry, and in many instances changed the way people fish for by introducing new tactics and products.

Bruce has previously been honored by the National Professional Anglers Association (NPAA) with a Lifetime Honorary Membership for his service to that organization, which is dedicated to help anglers develop the professional skill sets necessary to effectively represent and grow the fishing industry. Affectionately known as ‘The Chairman of the Boards’, a name given to him by Al Lindner and the In-Fisherman group, Bruce has continuously pioneered new markets and expanded the reach of Off Shore Tackle throughout the industry.

Besides being a talented angler and tireless businessman, Bruce DeShano is also a passionate family man. As a child, he grew up in a family that loved fishing and hunting. His father Lou and son Nick DeShano are his constant companions on and off the water. Fishing isn’t his only passion; when it gets cold, he loves to travel south and escape the snow. In the summer months, you can often find Bruce racing his Mustang at the local drag strip.

From working and retiring as a maintenance man for Detroit Edison to turning Off Shore Tackle Co. LLC into an internationally known fishing brand, Bruce epitomizes the American dream. His hard work and dedication to the sport of fishing and its anglers has made a large impact in the industry and touched many lives and he has no intentions of slowing down anytime soon.



Pictured here is Bruce DeShano, CEO of Off Shore Tackle, and 2020 inductee of the Freshwater Fishing Hall of Fame. This honor is the highest award given to anglers who are passionate about and successful in the sport fishing industry.

NEW HEAVY DUTY TATTLE FLAG WIRES FOR 2020

BY: JAKE ROMANACK

Off Shore Tackle is always looking for ways to make our products better. Case in point, the Off Shore Tackle OR12TF Tattle Flag™ Upgrade Kits turned the flag on our planer boards into an industry first strike indicator. This unique rigging uses a stainless steel spring, a plastic washer, two red OR16 Pro Clips, a screw eye and a length of stainless wire to create an articulating flag that tips down when a fish strikes!

Tattle Flags™ are so sensitive they indicate when a small fish or even a piece of floating weed or debris is snagged on the line. How cool is that? The Tattle Flag™ became a sensation overnight and has gone on to be one of the best selling products at Off Shore Tackle.

THE OR12TFEK TATTLE FLAG™ ECONOMY KIT

The next evolution in the Tattle Flag™ concept came in the form of the Economy Kit that provided the wire, stainless steel spring, plastic washer, split ring, screw eye and stainless bolt. Because most anglers who use the OR12 Side Planer already own a flag and a pair of OR16 Pro Clips, this economy kit made it easy for current customers to convert their boards over to Tattle Flag™ boards.

IMPROVED FLAGS

Within the last few years Off Shore Tackle introduced a second generation of their iconic board flags. These improved planer board flags feature a wider stem

with more holes to increase the spring tension settings on a Tattle Flag™. Available in both red (FLGSCR BE) and green (GFLGSCR BE), the improved flags were also an immediate hit with avid planer board users.

HEAVY DUTY WIRES

In keeping with this “never stop evolving” attitude, for 2020 Off Shore Tackle is releasing new heavy duty Tattle Flag™ wires. These improved wires are less likely to bend and do not require a bead. Simply switch out the standard wire for the heavy duty version and bent wires are a thing of the past.

The heavy duty Tattle Flag™ wires will be the standard wire in the OR12TF’s, OR12TFEK’s and as a replacement item in 2020.

SUMMING IT UP

At Off Shore Tackle the people who design our products are also avid anglers. Making our products as good as they can be is what makes Off Shore Tackle, “Your Leader in Trolling Technology.”

Editor’s Note: Jake Romanack is the co-host of the Fishing 411 TV series that broadcasts on Sportsman Channel and World Fishing Network.

OR12TF VS OR12TFEK

BY: NICK DESHANO

We offer 2 different Tattle Flag™ HD Upgrade Kits as aftermarket accessories for your OR12. The first is the Original OR12TF, which includes the HD wire, spring, necessary hardware, flag and two red OR16 Pro Clips to install on an OR12 Planer board. The other is the Economy kit, or OR12TFEK. The Economy kit has everything the Original has except WITHOUT a Flag or OR16's.

When fishing with monofilament line, the factory configuration of an orange OR19 on the bracket and a red OR16 on the back of the board will work great a majority of the time so you would just need to purchase the OR12TFEK Tattle Flag™ HD

Economy kit. The Economy kit also works great for anglers that use releases other than the OR16 on the bracket, such as the OR18 Snapper or OR39 Sam's Pro Release.

One might ask then, why would you want the full OR12TF Tattle Flag™ HD Upgrade Kit with the extra flag and the OR16's? Some anglers choose to use an OR16 on the bracket as well as off of the Tattle Flag™ HD wire. This configuration is used when you are using monofilament line and don't want the board to trip. When the rod line is placed behind the pin in each of the OR16's, that ensures that the board won't trip and/or come off of the line. The extra

parts and enhanced packaging are what makes the OR12TF more money.

In conclusion, for most anglers the OR12TFEK Tattle Flag™ HD Economy Kit is all that is needed. If you decide that you want to replace your flag (available in red or green to customize your preference) or need the extra OR16 to keep the OR12 secured on the line, they are available to purchase as aftermarket items and all of these items come under the price of the OR12TF. Instruction sheets are always available on our website if you need them.

TRICKING OUT YOUR PLANER BOARD

BY: MARK ROMANACK

You know you've become successful when your customers treat your products like a fashion statement! At Off Shore Tackle in-line planer boards are the heart and soul of our business. With countless anglers using these boards from coast to coast it stands to reason that guys and gals would want to put their own personal touches on their boards.

TATTLE FLAG™ HD RIGGING

Overwhelmingly the most popular option for the OR12 Side Planer Board is the aftermarket OR12TF Tattle Flag™ HD Upgrade Kits. Adding a Tattle Flag™ to an OR12 Side Planer converts the flag into a spring loaded and articulating flag that indicates when a fish has been hooked. A simple linkage system means that you'll never inadvertently find yourself dragging a fish again. Tattle Flags™ are so sensitive they not only indicate when a game fish has been hooked, the flag will tip down even when a small trash fish or even a piece of floating weed catches on the line!

Tattle Flags™ are considered "must have" items among walleye anglers who are often trolling with live bait, at slow speeds and in rough water. Tattle Flags™ are however just as handy for the salmon angler who needs to know when a small "jack" has been hooked. Tattle Flags™ can be added by

purchasing an OR12TF Tattle Flag™ HD Upgrade Kit or by purchasing the OR12TFEK Tattle Flag™ HD Economy Kit. Off Shore Tackle dealers coast to coast stock these popular items.

MUSICAL LINE RELEASES/CLIPS

One of the features that makes Off Shore Tackle planer boards so functional is they can be rigged with a host of different line releases and clips. Off Shore Tackle manufactures the industry's largest selection of traditional line releases/clips designed to function with monofilament, co-polymer and fluorocarbon line types. The OR10, OR14, OR19 releases and OR16 Pro Clips can all be rigged on any OST in-line planer board.

For those anglers who prefer to troll using low stretch and ultra thin super lines, Off Shore Tackle also has this category covered. The OR18 Snapper and the OR39 Sam's Pro Release are both designed to be used with braided and fused super lines. The OR18 Snapper is used when you don't want the board to trip and keep both releases attached to the line until it is removed from the line at the boat. If you prefer to "trip" the board (having the line come out of the bracket release to enable the board to be retrieved without it planing out to the side), the OR39 Sam's Pro Release was designed specifically for that use.

When trolling in rough water or at exceptionally fast trolling speeds the OR17BWW and the OR30BWW Medium and Heavy Tension Planer Board Releases can also be rigged to OST in-line planer boards.

REPLACEMENT RUBBER PINCH PADS

For anglers who fish a lot, Off Shore Tackle offers replacement rubber pads for all of their line releases and clips. Often these products are not a regularly stocked item at retailers, but they can always be ordered on line at www.offshoretackle.com.

HARDWARE UPGRADES

The OR12 Side Planers come standard with stainless bolt and nylon nut. Vibration can cause these nylon nut to loosen up. For added security, the instructions on the OR12 states to check the bolt/nut tightness prior to setting the board out each time. However, many anglers prefer to solve this problem by upgrading to a 6/32 stainless lock nut available at either Off Shore Tackle or your local hardware store.

Anglers can also purchase stainless split rings for attaching all releases to the bracket of in-line boards. Many anglers feel that using a split ring to attach planer board releases allows the board to function better when trolling in exceptionally rough water conditions.

COLOR ME FLAG

Every OR12 and OR37 SST Pro Mag in-line board comes standard with a red flag. If you prefer, those flags can be switched out for green flag models.

Many anglers prefer to run one side of the boat with red flags and the other side of the boat using green flags. Charter captains often choose this option to make it easier for their customers to know which boards are to be used on which side of the boat!

NIGHT FISHING

For those anglers who troll into the dark, a small cylume stick can be easily taped to the stem on the flag. This simple trick makes it possible to see board strikes even in the dark. Putting lights on your planer boards also makes it easier for other anglers to know where your gear is running.

Chemical cylume sticks typically last about 8 to 12 hours making them perfect for a long evening of fishing.

BRACKET TRICKS

A lot of our board customers prefer to mount two line releases to the bracket of the OR12 and OR37 SST Pro Mag boards. This option makes it possible to remove a board using just one hand, speeding up the process of getting the board off the line when fighting a fish.

The brackets on these boards come factory drilled to accept the second release.

THE WEIGHT GAME

The OR12 and OR37 SST boards come with a counter balance weight factory mounted in a channel molded into the bottom of the board. This weight is held in place with a stainless screw that can be removed allowing anglers to move the weight for specific trolling situations.

Moving the weight forward brings the nose of the board down and allows the board to pull more weight such as sinking lines like lead core, stranded copper line or the improved HD stainless steel wire provided in the Tattle Flag™ upgrade kits (if you converted your OR12 with the Tattle Flag upgrade).

SUMMING IT UP

In short, there are lots of different ways to rig an Off Shore board. No matter how an angler trolls or for what species, there's a perfect OST option out there for the serious in-line board troller. So if tricking out your boards trips your trigger... Have at it ladies and gentlemen.



One of the reasons Off Shore Tackle in-line planer boards are so popular is they can be rigged in a host of ways making them ideal for literally every trolling application. Jamie Robinson of Wawa Ontario routinely uses his Off Shore boards to target salmon like this chinook from Lake Superior.

GETTING DEEP WITH TADPOLE DIVERS

BY: BRANDON WHITE

We all know that fishing can get expensive, especially for the weekend warrior. When it comes to Great Lakes fishing, the amount of rod and reel setups required can quickly get out of hand. Growing up all I did was small inland lake fishing. As I grew up and realized the Great Lakes fisheries I had in my back yard, my interest grew. I gained salmon experience on a friend's charter boat and always enjoyed it but could never do it myself because I didn't have the correct gear. Around the same time, I was introduced to Lake Erie walleye fishing by the Romanack's (Fishing411) via winning a Niagara fishing expo contest.

I made up my mind I was going to rig my boat to take full advantage of both Lakes Erie and Ontario. The first chore was getting my head wrapped around all the rod and reel setups I would need to target salmon, trout and walleye. I knew I was going to need gear suitable for downriggers, Dipsy Divers, lead core, copper line, weighted stainless steel, monofilament and

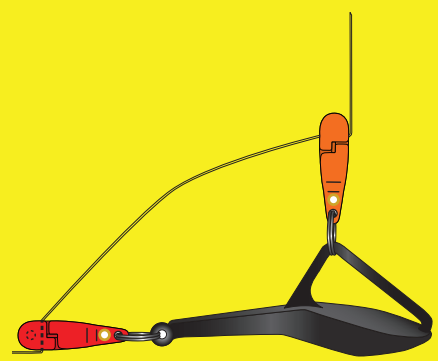

the list goes on. The process of learning how to use all this gear was a little frustrating to say the least. The first time I went out for walleye on Erie, the 3 color lead core set up was catching the majority of the fish. Unfortunately, at the time I didn't have a second one to maximize this opportunity. So for the next trip I rigged up another 3 color. On that trip the 5 color was the best depth. You can see where this is leading. I ran into this same problem my first season going after king salmon. A 10 color lead core wasn't getting me deep enough, so I invested in a 300 copper set up. That worked great until I needed to get deeper. If I kept on this road, I was going to spend a lot of money on dedicated rods, reels and specialty lines.

Fortunately, I learned a great tip recently while fishing on a friend's charter boat. He uses an Off Shore Tackle OR36 Tadpole Diver rigged with an OR19 (orange) release on the tow arm and an OR16 (red) Pro Clip mounted to the tail of the Tadpole. When fishing lead core or copper wire set ups he lets out all the sinking line and then attaches the Tadpole Diver to the backer line. Adding a Tadpole is an easy way to get any sinking line setup to run deeper. When a fish is hooked, the Tadpole Diver releases from the tow arm release and simply hangs on the line like a Snap Weight. The OR36 series Tadpole Divers come



Brandon White fishes Tadpole Divers frequently on both Lake Erie for walleye and as pictured above, Lake Ontario for salmon.

in four sizes including No. 1, 2, 3 and Mag versions. By investing in a few Tadpole Divers I'm now able to target all the depths needed to catch walleye, trout and salmon using the same monofilament trolling lines I already own for walleye trolling. I can also take any

lead core setup I own and get it to run deeper by simply adding the Tadpole Diver. Instead of investing in a pile of rods, reels and specialty lines, I've found it more economical to stock up on Off Shore Tackle's OR36 Tadpole Divers!

SRT'S MAKE RIGGING EASY

BY: LARRY HARTWICK

Anyone who uses planers whether it's in-line or collapsible dual/triple boards understands the importance of separating their rods rigged to their planer boards. Keeping a good separation on the rod tips virtually eliminates tangles. For years the only option was rod holders spaced along the gunwale set at different angles. We now have a better option with the rods spaced vertically with different angles on the rod holders. This results in a much larger separation on the lines running to the planer boards which eliminates tangles, frustration, less clutter and less confusion in the cockpit. The area that was occupied by rods spaced along the gunwale is now open to set lines and net fish. With the rods all in 1 location per side, access is easy. The Riviera Swiveling Rod Tower (SRT) changes how planers can be fished. Each rod holder is adjustable in 15 degree increments allowing the rods to be set at your preferred angle. All the tubing is constructed from heavy wall aircraft aluminum that is then powder coated so it looks good for years. The top



of the rod holders are fully radiused to be easy on your rods and eliminates the need for a vinyl cap. The most popular units feature 3, 4, or 5 rod holders per unit. Need to remove them? Riviera is the only company that has a base that enables the user to remove or replace the SRT in seconds. Simply pull out the spring loaded pin in the base and lift out or insert the vertical tube into the base. Simple and extremely strong. The base is mounted to a mounting plate (included) using 4 - 5/16" thumb screws. The base can also be attached to an optional mount (SRTTA) that can be used on most permanently mounted tracks. The base also allows the unit to be locked into position every 90 degrees, allowing the unit to be facing out, towards the bow, towards the transom, or into the cockpit for docking, trailering or running. No one else has this feature.

CHAOS MANAGEMENT WITH THE OR39 SAM'S PRO RELEASE

BY: BARB CAREY

Years of hard work, shared knowledge, and extensive studying have impacted positively on my trolling game. Board rigging tactics that allow me to catch fish on outside lines without the need to clear inside lines is paramount to a fish in the net! The OR39 Sam's Pro Release is designed to function with super braid and fused fishing lines. This adjustable line release can be run rigidly on the bracket of the OR12 Side Planer or the OR37 SST Pro Mag by using the included lock nut or loosely attached via the included split ring. I rig my boards with a Sam's Pro Release on the bracket and an OR16 Pro Clip on the tail of the board. Open the plunger arm and wrap the line around the Sam's Pro Release three to four times before closing the arm. After securing the Sam's Pro Release, place the line in the red OR16 Pro Clip leaving a little slack between the two releases. This trick allows the board to ride more freely on the surface of the water. The Sam's Pro Release also has a set-screw setting

that makes it possible to control the amount of tension required to trip the release. This feature makes it possible to troll at virtually any speed and for any species. The OR39 Sam's Pro Release, allows the board to release and disengage its side-planing movement, when triggered. Once the release has been triggered, the fish can be retrieved directly behind the motor, not disturbing the other lines. I find the Sam's Pro Release especially beneficial when in an unpredictable fight with king salmon and other Great Lake's monsters of the deep. Fighting for their lives, the rods are loaded to the max. Feeling every bit of the fight of the fish and being able to control the direction of the fish during the fight is the difference between a fish in the net and a barrage of cuss words. The design of the OR39 Sam's Pro Release allows the release on the front of the board to become detached from the line, allowing the board to hang freely by the red OR16 Pro Clip. The inside of the clip has a pin protruding through the pads that holds

the line secure and keeps the board attached onto the line. Be sure to place the line behind the pin to prevent the board from detaching from the line. Over time the rubber pads on the OR16 can wear down, which could allow the line to prematurely release from the pin. You can replace the worn pads with the ORRP16HL replacement pads. As an extra precaution, you can also wrap the line around the opening of the clip several times to prevent it from accidental early release. Using the Sam's Pro Release makes me feel like I have control where the fish go, as opposed to frantically clearing lines to prevent a tangled mess. From crappies to king salmon, I can count on Off Shore Planer Boards and the OR39 Sam's Pro Release to deliver a competitive advantage in my trolling game. Editor's note: Barb Carey is a long time Off Shore Tackle Pro Staffer, a licensed charter captain and the founder of the organization Wisconsin Women Fish.

BOARD SLIPPING FOR MONSTER CATS

BY: MARK ROMANACK WITH CHRIS SOUDERS

Some of the biggest channel and blue catfish these days are caught with the help of an Off Shore Tackle planer board! Off Shore Tackle Pro Staffer Chris Souders has pioneered using a unique board trolling/slipping setup that is deadly on river cats. Anyone who has fished while drifting with the river current will quickly appreciate the setup Chris Souders uses to target structure loving catfish while avoiding snagging his gear.

GETTING STARTED ON RIVERS

Chris recommends pointing the boat into the current and using an electric motor to control the drifting speed of the boat. “Ideally I’m trying to get the boat to drift downstream at about half of the current speed,” says Souders. “Slowly allowing the boat to slip downstream is an efficient means of covering water and also allows planer

boards like the Off Shore Tackle OR12 and OR37 SST Pro Mag to be deployed out to the side of boat. With the help of planer boards, I can spread out my baits, cover more water and target different depths effectively.”

BOARD BOBBERS

Once the boat is slowly slipping downstream, Chris goes to work deploying his lines. A sinker is added to the terminal end of his fishing lines along with a short leader and live bait like a moon-eye, cut bait and also other baitfish. “I let out just enough line so my weight is hanging near vertical and positioned two or three feet off the bottom,” advises Souders. “This setup allows me to clip on a planer board and let the current pull my boards and catfish rigs out away from the boat. Essentially the board is suspending my baits just above the bottom so I can slide downstream over top of fish holding structure without my gear snagging on the bottom.” Depending on the water depth and current speed, different sizes of weights are needed to maintain the near vertical presentation. “The OR12 Side Planer will handle weights up to about three ounces,” adds Souders. “If I need more weight to stay vertical that’s when I use the OR37 SST Pro Mag Board. Most days, I’m using both the OR12 and OR37 so I can cover a variety of water depths.” When a fish strikes the planer board telegraphs the strike. Souders uses a

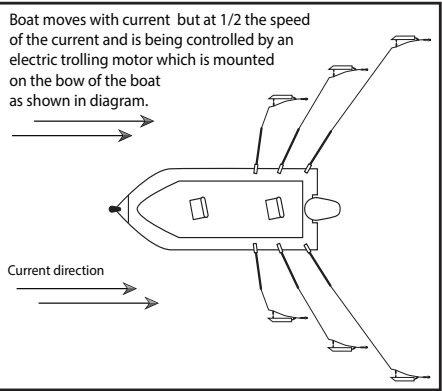

pigtail swivel mounted at the tail of his boards so he can release the board when a fish is hooked and then allow the board to slide down the line. The board stops when it gets to the sinker, in the perfect position for netting a big catfish.

FORWARD TROLLING

This same setup can be modified for forward trolling when targeting cats living in large impoundments. Using an electric motor to troll slowly forward accomplishes the same goals of spreading out lines and keeping gear suspended in the water but near the bottom. Forward trolling may require more weight to position baits near bottom, depending on the water depth and also the trolling speed. Cats can be found scattered across flats, but they tend to concentrate in areas where rock piles, structure breaks or submerged wood on the bottom gives them cover in which to lay in wait for food.



Chris Souders has pioneered the use of some unique and highly effective trolling tactics when targeting monster cats like this.

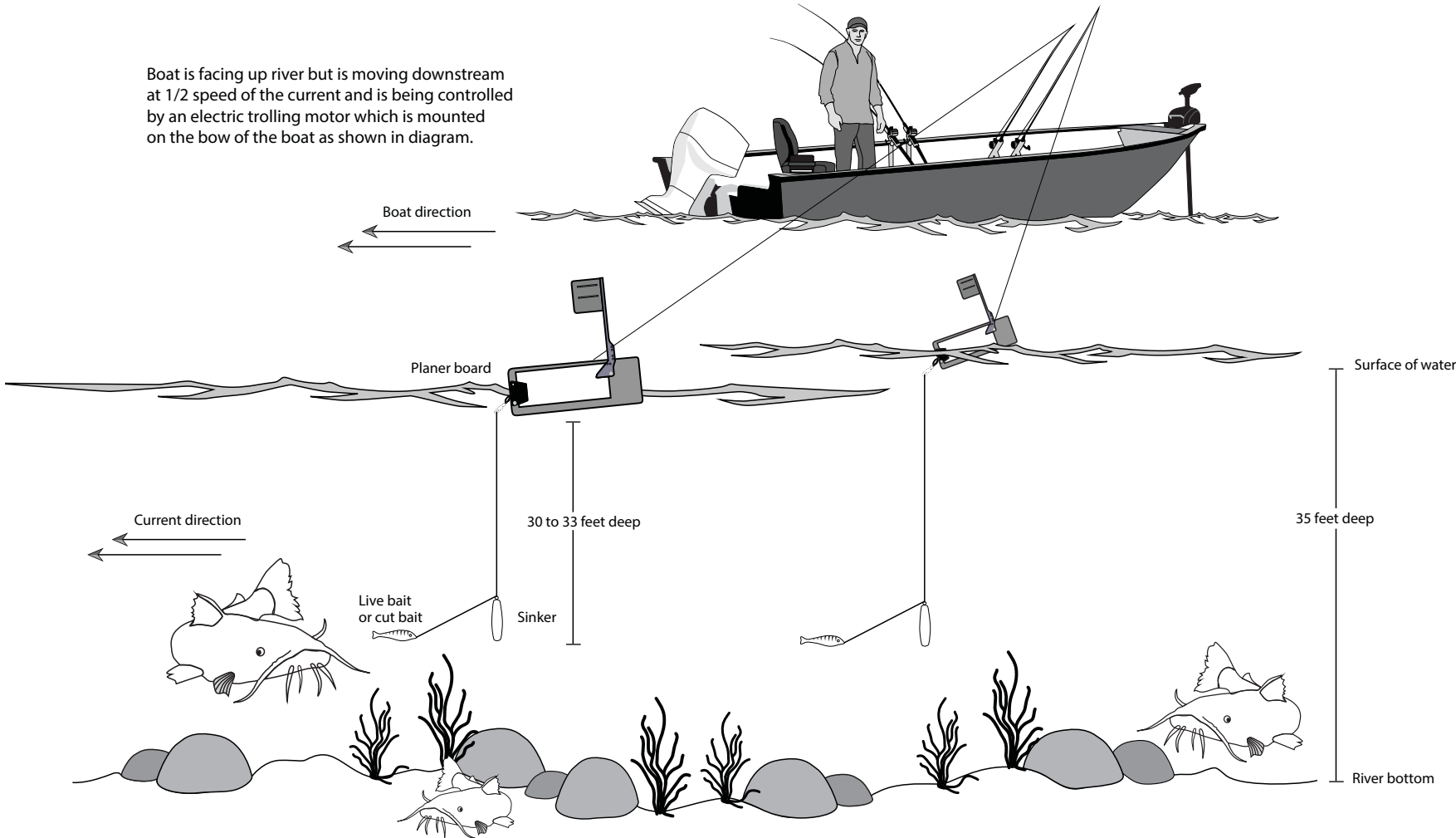

WANTED

Attention retailers that carry Off Shore Tackle products! We are looking to add you to our list of RETAILERS on our website. Please email us at otcproducts@yahoo.com with your company name along with your location and web address (if you have one) for you to be added. If you happen to be missing out on carrying our products, we would be more than happy to supply you with a list of distributors that would happily accommodate you in adding the Off Shore Tackle products!

LOOKING FOR SOMETHING

Maybe you missed some of our past editions of the “Off Shore Release”, or are need of more information on our products and their usage. All of this information is always available 24/7 on our website, www.offshoretackle.com!

HEAVY SNAP WEIGHTS AND THE SST PRO MAG



Our friend Tony Puccio is life long member of Off Shore Tackle Pro Team, the former owner of Bait Rigs Tackle and one of the finer fishing communicators in the business

BY: MARK ROMANACK WITH TONY PUCCIO

Lots of anglers enjoy catching lake trout, but not everyone has the luxury of owning downriggers. Catching these denizens of the deep when you don't have downriggers is a job for the Off Shore Tackle OR37 SST Pro Mag planer board and some heavy weight rigged using the OR16 Pro Clip (this weight/clip setup is known as a Snap Weight).

"I rig up three different size weights including 6, 8 and 10 ounce sinkers by simply attaching them to the red, OR16 Pro Clip with a split ring," explains Tony Puccio. "The OR16 Pro Clip features a pin protruding through the center of the rubber jaw pads that ensures trolling weights stay firmly fixed to the line at all trolling speeds and also when fish are hooked. When a fish is hooked, I simply reel in the fish until the Snap Weight comes to the rod tip, remove it

quickly and continue fighting the fish to net."

This simple trolling system is deadly effective and very economical. At lake trout trolling speeds (1.5 to 2.0 mph) the six ounce weight will run roughly 50 feet, the eight ounce weight gets down to about 70 feet and the 10 ounce weight will fish down to about 100 feet of water.

"Because these large sinker weights have a lot of resistance in the water, I use the SST Pro Mag planer board to spread out my lines and cover more water," adds Puccio. "The lighter weights are fished on an outside board and the heavier weights are rigged on inside board lines."

With this simple deep water trolling system, Puccio can use the same trolling rods, reels and lines he also uses for other species like walleye.

ATTENTION TO DETAIL

BY: ZACHARY JOBES

Attention to detail can make all the difference when it comes to perfecting a trolling game. A recent survey showed that trolling is the top money-winning tactic on the National Walleye Tour. Trolling gives anglers the chance to not only cover a large amount of water fast but also to pick off the active fish that are in an area.

One method I use frequently is trolling structure areas with deep diving crankbaits such as Berkley Flicker Shads, Reef Runners, and Rapala Husky Jerks. I use my electronics mapping feature to find the edges of the reef, rock pile or steep shoreline drop and position my crankbaits as close to bottom as possible.

Often times the structure I am trolling is a very small area so moving all of my rods and planer boards to the shallow side of the boat can trigger more strikes. For instance, if I am on the edge of a reef or rock pile that tops off at say 10 feet, I will troll the edge of the reef and keep my boat in 14-18 feet of water. By positioning all of the boards to one side of the boat (usually the shallow side) I can make sure my baits are nearest to the structure edge while keeping my outside board on top of the structure.

During daylight hours many fish stage on the edge of the structure and wait until low light conditions to go up on top of the structure to feed which is why this method can be so successful. When setting your baits you want to run your outside bait shallowest and your inside bait deepest.

Although this can be an extremely effective way to put fish in the boat it can also be very frustrating at times as you will often snag crankbaits on the structure. One thing I highly encourage is upgrading the OR12 Side Planer boards with the OR18 Snapper Release onto their brackets. This ensures that the board will never become detached from your line even if the board sinks under water when a crankbait becomes hung up or snagged.

The use of braided line can also help to apply more pressure and free snagged baits from the bottom. Super braid lines also add a little more action and increased diving depth to your crankbait.

Another great tip is to always make sure your crankbait is running straight in the water before resetting your line. Sometimes when a bait is banging bottom it can get knocked "out of tune". The Off Shore Tackle OR40 EZ Crankbait Tuner is the ideal tool for tweaking crankbaits to make sure they are running straight and true.



Zak Jobes is an open water walleye trolling expert and one of the rising stars on the National Walleye Tour.

ANNUAL BOARD MAINTENANCE TIPS

BY: MIKE WAGNER

When the winter approaches each year, it means equipment maintenance chores. I thought I would share a couple of tips for annual maintenance on your Off Shore Tackle in-line planer boards that will keep your boards looking brand new.

I start by stripping the board of all releases, clips,

springs, screws, and so on. Then I clean the board with Windex to remove any surface dirt, etc. After using the Windex, I use a Mr. Clean Magic Eraser to thoroughly clean the board. The eraser helps to remove scuff marks, stains and old markings. Be careful not to use Magic Eraser on any graphics, as it does

have light abrasion to it.

Once thoroughly cleaned, I apply two coats of spray wax to leave the board looking like new. Lastly, reassemble the board and replace any worn parts like flags or release pads as needed. Now your planer boards are ready to roll for next season.

THE OFF SHORE TACKLE MISSION STATEMENT

Our company's foundation is based on presenting products to the consumer that result in a more productive fishing experience. We strive to use the best available materials that are as eco friendly as possible. Our products are "Often Imitated but Never Duplicated". You can buy cheaper products, but you can't buy better designed, built, longer lasting or more functional trolling products than those produced by Off Shore Tackle and Riviera Trolling Systems. That's why Off Shore Tackle LLC remains your "Leader in Trolling Technology."

TUNING CRANKBAITS FOR BETTER FISHING SUCCESS

BY: MARK ROMANACK

Crankbaits are amazingly effective fishing lures. Sometimes I marvel at how well these plastic or wood minnow imitators perform on a wide variety of species including walleye, brown trout, lakers, bass and even salmon. If crankbaits have an Achilles heel it’s the fact that not all of the hundreds of cranks on the market come out of the package ready to fish properly. Often crankbaits need a little “adjustment” to convert them into the fish traps they were intended to become.

WHY ARE CRANKBAITS NOT ALWAYS IN TUNE?

Plastic crankbaits often end up not in tune because they are designed to be two identical halves that are hand glued or sonic welded together to form a water tight and finished lure. If this gluing or sonic welding process is only slightly off kilter, the bait will not be perfectly balanced and will swim in the water favoring a course that is either left or right of center.

In the case of wooden crankbaits, the diving lip must be installed by machining a small slot into the nose of the lure. The diving lip is then glued into place. Small imperfections in how the diving lip is installed of course can cause crankbaits to perform differently from lure to lure.

CRANKBAIT TUNE

Crankbaits often suffer from the failing of not being properly tuned. A tuned crankbait will run straight in the water at all common trolling speeds, dive to its intended maximum fishing depth and also deliver its maximum life-like action. A lure that is “out of tune” generally runs right or left of center, causing the bait to canter slightly in the

water and killing the lure’s ability to dive properly.

Out of tune crankbaits simply don’t catch many fish and the problem is many anglers are not skilled enough at “tuning” a crankbait to correct the situation. An angler who doesn’t know how to properly tune a crankbait will soon find himself frustrated with the process. A rookie at the art of crankbait tuning often makes a bad lure worse instead of better.

PULL POINT ADJUSTMENT

Tuning a crankbait requires making very minor adjustments to the lure’s wire pull point or what is often called the line tie. Located on the lure’s diving lip, the operative word here is minor because it only takes a very small adjustment to dramatically change the way a crankbait is running.

Lures that are running to the left of center will require the pull point to be slightly bent to the right to correct this situation. Lures that are running right of center will need the pull point bent to the left for correction.

The process of bending the pull point is fairly straight forward, but it requires trial and error to achieve the desired results. Often a crankbait that is seriously out of tune is subjected to so many adjustments the wire on the pull point becomes softened to the point it will no longer support the lure running in a predictable manner.

THE EZ CRANKBAIT TUNER

Thankfully a new tool designed especially for tuning finicky crankbaits is on the market. Known as the Off Shore Tackle OR40 EZ Crankbait Tuner, this unique pair of pliers features a slip clutch jaw design. One half of the jaw on the EZ Crankbait Tuner is long and slender and the other half of the jaw is shorter. This feature allows the long jaw



The EZ Crankbait Tuner is a simple to use tool that makes tuning any crankbait a please.

to be positioned against the lip of the crankbait while the short jaw is placed against the wire pull point. This fundamental design gives the angler more control to make very small adjustments to the pull point.

The slip clutch features an adjustable spring tension located right at the junction where the jaws come together. Applying more or less press to the slip jaws makes it possible to tune crankbaits of different sizes that feature different wire diameters on the pull point or line tie.

When the clutch on the OR40 EZ Crankbait Tuner slips you will hear a loud click. To reset the tuner for another adjustment, simply use your thumb and forefinger to click the jaws back together. This “resetting step” MUST be taken each time an adjustment to the lure’s pull point is made.

The process of using the EZ Crankbait Tuner is easy. First, make sure the slip jaws are reset by pinching them together until they click. Then place the long jaw on the edge of the crankbait’s diving lip and the short jaw on the wire pull point. Squeeze the handle on the EZ Crankbait Tuner until the jaw slips

and clicks again.

A small adjustment has been made to the wire pull point. Cast the crankbait to see how this adjustment has impacted on how the lure is running and then make another adjustment as needed until the lure is running and diving straight down into the water.

The adjustable spring tension on the slip jaws helps tremendously in the process of determining how much pressure is needed to adjust various different design and sizes of crankbaits. The EZ Crankbait Tuner can be used to tune all crankbaits from oversized saltwater and muskie lures to pint-sized walleye and crappie baits.

SUMMING IT UP

Off Shore’s OR40 EZ Crankbait Tuner takes the trial and error out of tuning crankbaits. With a little practice this tool becomes intuitive to use, making sense out of what has historically been a complex and confusing process. Even better, the EZ Crankbait Tuner can turn “dud” crankbaits into fish catchers once again.

CONQUERING THE WEEDS!

BY: CRAIG MICHAELS

As a walleye tournament angler, I find myself fishing in weedy conditions often. Experienced walleye anglers know that big walleye can be found in and around weed beds, but fishing the salad can be challenging. There are lots of different weed types, but cabbage weeds (common pond weed) are the type of aquatic growth I look for. Cabbage weed attracts perch, blue gills and a host of baitfish species walleye prey on.

The OR20 Pro Weight System contains an assortment of lead free weights we call Guppy Weights that can be fished as an in-line weight or rigged on an OR16 Pro Clip, known in the industry as a Snap Weight. I primarily use the ½, ¾ or 1oz. Guppy Weights for weed fishing. The water clarity and water depth will determine the weight size and how far in front of the bait to position the weight.

On one side of the boat I use an in-

line Guppy Weight positioned 4 to 7 feet in front of a crawler harness. I then let out just enough additional lead length so the weight ticks to top of weed beds. At this point I attach an Off Shore Tackle OR12 Side Planer with the OR12TF Tattle Flag™ HD Upgrade Kit installed. I recommend setting the flag with just enough tension so if a weed hangs up on the weight or bait, the flag will tilt and alert you.

On the other side of the boat I use a Guppy attached to an OR16 (red) Pro Clip with either a crawler harness or minnow imitation bait and then let out 25 to 35 feet of line, attach the Snap Weight then proceed to let out an additional 25 to 35 feet of line. I complete this set up by attaching an Off Shore Tackle OR12 Side Planer with the OR12TF Tattle Flag™ HD Upgrade Kit.

Because in Michigan waters three



Craig Michaels is a tournament pro and a long time member of the Off Shore Tackle Pro Team. When Craig isn’t fishing tournaments you can find him working sports shows helping others to be more successful on the water.

lines per person are allowed (during the time this article was written), my partner and I will rig 3 lines on each side of the boat. The ½ ounce weight is run on the outside board, the ¾ ounce weight on the middle board, and the 1 ounce weight on the inside board. After fishing for a while, the fish

CONTINUED ON PAGE 7

FISHING WITH SUPER LINES

BY: MARK ROMANACK

A growing number of anglers are discovering that braided and fused “super lines” are ideally suited for many trolling applications. The ultra low stretch

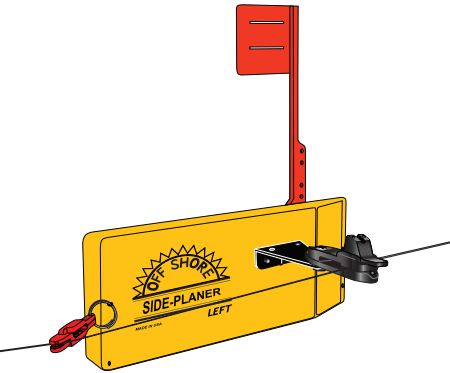

associated with these lines makes them ideal for delivering rock solid hook sets. Also, super lines are thinner in diameter for the break strength than traditional nylon lines, making them a good choice for getting trolling gear to greater depths. It’s also true that super lines are resistant to UV rays, exceptionally abrasion resistant and they tend to last much longer than traditional lines making them a good value.

If there is a down side to fishing with super lines it’s that most planer boards and planer board releases were never engineered to be used with these unique line types. Because super lines are ultra thin and slick surfaced, they simply don’t function very well in traditional pinch pad style line releases. In fact, using super lines with traditional pinch pad style line releases literally destroys the rubber pads in no time flat!

Never fear, because Off Shore Tackle is here with a complete line up of releases and clips that are designed to function with super lines.

OR18 SNAPPER RELEASE

Some years ago when super lines first became popular, Off Shore Tackle responded by introducing the OR18 Snapper Release. The cam design of this line release is engineered to hold thin and slippery super lines securely. A tension adjustment screw allows anglers to tighten the jaw pressure enough that braids and fused lines can’t slip no matter what the line diameter or trolling speed.

The Snapper Release mounts perfectly on the bracket of the OR12 Side Planer and instantly became a success among anglers who prefer trolling with super lines. Snapper releases also have another overlooked advantage. The cam design allows this release to be opened with one hand, making it simple and very quick to remove from the fishing line when reeling in a board and hooked fish.

Even though a second added feature of the OR18 allows you to trip your planer board (line releasing from the release on the bracket), we feel the OR18 is best used when you don’t want your planer board to trip.

OR39 SAM’S PRO RELEASE

The Sam’s Pro Release was designed by a west coast based company known as Silver Horde. This unique line release has been on the market for many years, but only recently have anglers outside the Pacific Northwest known about this product. Off Shore Tackle recently entered into an exclusive marketing agreement to distribute and promote the OR39 Sam’s Pro Release.

Just like the OR18, the OR39 Sam’s

Pro Release can be used with both braided and fused super lines. The Sam’s Release mounts perfectly onto the bracket of both the OR12 and OR37 SST Pro Mag using the provided stainless steel bolt and lock nut. This special line release can also be mounted to the board bracket using a split ring for those who troll in exceptionally rough seas or at very high trolling speeds.

The OR39 can be rigged to function as a traditional line release. A jettison arm on the Sam’s release allows super lines to be wrapped onto a rubber plunger. When the jettison is closed, the super line is held securely on the rubber plunger. When a fish strikes, the angler can trip the release by simply giving the rod tip a short snap, popping open the jettison arm and allowing the line to uncoil smoothly from the rubber plunger.

A set-screw adjustment allows the tension on the jettison arm to be controlled for virtually any lure type, line diameter and trolling speed. When fished in

that the line can be tripped from the bracket release, yet remain fixed on the fishing line thanks to the Snapper Release at the tail of the board.

Rigged in this manner anglers can stack multiple planer boards on each side of the boat and as desired trip the board and reel in hooked fish without having to clear other board lines. Rigging in-line boards so the line can be tripped or released from the bracket, yet the board remains pinned in place on the line is a special feature. This rigging allows the board to spin around in the water when released from the main line, preventing the board from planing and making it much easier for the angler to reel in the released board and hooked fish.

Because the board is no longer planing, hooked fish do not gain the leverage they need to tear free and escape. Rigging in-line planer boards to release from tow line, yet remain fixed on the line is pure genius and a function you can only get with Off Shore Tackle products.

SUMMING IT UP

Off Shore Tackle produces the most extensive line up of traditional and non-traditional line clips and releases on the market. No matter what brand, diameter or style of super line an angler might choose, there is an Off Shore Tackle line release or clip perfect for the job.

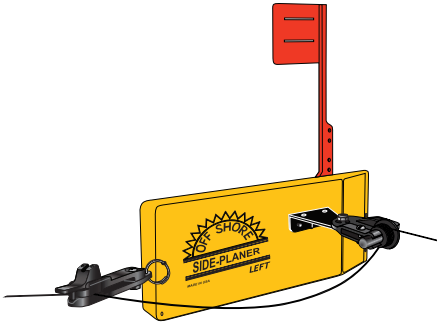

combination with the OR18 Snapper Release at the tail of the board, anglers enjoy the best of both worlds. In short, the Sam’s Pro Release allows anglers to rig their planer boards in such a way

GREAT LAKES MUSKIE; BIG BOARDS + BIG CRANKS = BIG FISH

BY: JASON PLANT

When most people have winterized their boats and are wrapping up their Christmas shopping for the upcoming holiday, hardcore muskie anglers on the Great Lakes are looking forward to south winds, that bring with them calm waters along the south shore of Lake St. Clair. When you’re targeting a fish with a nickname like ‘the fish of 10,000 casts’, sometimes the best thing to do is to put down the casting gear and get to trolling. The only problem is, when its late fall on Lake St. Clair, standard size equipment just won’t do.

In the late fall as the water cools, large schools of baitfish congregate at river mouths along the shoreline of Lake St. Clair, and as they say at the ‘muskie factory’, find the bait and you will find the muskie. When the water dips in to the low 40’s, these big fish are looking for big meals, and flat-sided crankbaits of 10 inches or larger are a perfect imitator of these big Great Lakes shad.

These big baits pull very hard, add an Off Shore Tackle OR20 Series Guppy Weight of 2 or 3 ounces, and you’ve got a presentation with a ton of resistance. Even when you’re trolling at the modest speed of only 3 miles per hour in the fall (it’s not uncommon to troll at speeds up to 5 mph in the summertime), this presentation creates a great deal of resistance.

In the last couple of years, we have discovered that the OR37 SST Pro Mag is the perfect board for this type of fishing. However, you will need to beef up all of your trolling equipment to get the job done. I prefer 700 or 800 series Shimano

Tekota line counter reels, spooled with 40-60 lb. big game saltwater monofilament line, paired with 8’6” to 9’ heavy action trolling rods. To keep these toothy critters from swimming away with your highly coveted, high dollar crankbaits, 150-180 lb. fluorocarbon leaders are a must.

I was fortunate enough to experience an epic day of fishing with this big fish setup on Lake St. Clair during the first week of December, 2017. Shimano National Pro Staff manager, Blaine Anderson, accompanied me and fellow muskie hunter, Talbert Turner on a late fall muskie hunt. We trolled Off Shore Tackle’s OR37 SST Pro Mag planer boards, pulling 10 inch flat sided crankbaits at 3 mph, over the same 1 mile stretch all day long. We wound up boating 11 fish that day over 44 inches long, anchored by a 52” x 25” trophy that would get any musky nut drooling. This is surely a day none of us will forget.

The fall is by far my favorite time of year. As the air cools, and the leaves begin to change, I spend many Saturday afternoon’s watching college football. On many of these occasions though, I seem to lose focus on the game on the television. My mind drifts to a crisp fall day on Lake St. Clair, and I can’t help but think of seeing my SST Pro Mag’s sinking back, with the anticipation of another big fall musky hitting the net.

CONQUERING THE WEEDS! CONTINUED FROM PAGE 6

BY: CRAIG MICHAELS

will let you know which presentation, in-line Snap Weight combination is most productive. Once the fish dictate which setup they like best, we then switch over and fine tune the presentation from there.

The reason this rig works so well is the Guppy Weights put your bait

in the strike zone and the weeds get hung up on the weights instead of on your bait. Fishing in the weeds does take patience and some practice, but with the help of the OR20 Pro Weight System catching walleye in the weeds is a snap! Off Shore Tackle offers the OR16’s and Guppy Weights as

aftermarket items so you can purchase exactly what you need and make your own custom version Pro Weight System.

Editor’s Note: Craig Michaels is tournament fisherman with over 25 years of experience. Craig is also a long time Off Shore Tackle Pro Team member who regularly works the Off Shore Tackle booth at consumer sport shows.

FIVE FOR FIVE, TACKLING ALL FIVE GREAT LAKES IN A SEASON

BY: MARK ROMANACK

The thing I like most about being the Executive Producer for the Fishing 411 TV series are the places we get to visit and fish. Traveling to new fishing destinations and learning about different fisheries keeps the fishing game interesting. In any given year our crew routinely fishes on all five of the Great Lakes.

For those who live to fish, targeting all five Great Lakes in a season is an impressive goal worth giving serious thought. The list of places an avid angler should visit is endless, but here is a little encouragement to help the process take root.

LAKE SUPERIOR

Lake Superior is the largest of the Great Lakes and also the most water with the least amount of fish! Finding world-class fishing in Lake Superior requires an understanding of the lake and exactly when and where to focus your fishing attention.

Hands down the most unique fishery in Superior is a reef complex located nearly in the middle of the lake. The famed Stannard Rock is a shoal that is approximately one mile wide and five miles long. This shoal can be reached by boat from several Michigan ports including Marquette (55 miles), Loc La Belle (37 miles) or Copper Harbor (38 miles).

Stannard Rock is most famous for the trophy class lake trout that are routinely caught here. Casting and jigging tactics are both productive ways to catch the lake trout of a lifetime.

LAKE MICHIGAN

Once considered the best salmon fishing in the world, Lake Michigan has been witness to some major changes in recent years. The alewife forage base that for decades fueled salmon stocking is currently struggling to maintain itself. These days Lake Michigan is re-

ceiving a much smaller salmon stocking program in an effort to keep the forage base from being over-harvested and crashing.

Currently the best salmon fishing in Lake Michigan takes place along the Wisconsin side of the lake at ports including Sheboygan, Manitowoc and Kewaunee. The Wisconsin Department of Natural Resources is currently stocking the largest number of king salmon in Lake Michigan. These fish migrate from southern Lake Michigan in early spring to the Wisconsin side of the lake in June, July and August. Fish that can tip the scales at 25, 30 and even 40 pounds are being produced on a regular basis.

If your goal is to catch the biggest king salmon of your life, the place to do it is on the Wisconsin side of Lake Michigan.

LAKE HURON

The trout and salmon fishing of Lake Huron once rivaled Lake Michigan. Unfortunately some years ago the alewife forage base on Lake Huron crashed, leaving fisheries managers with little recourse but to cut stocking efforts back significantly. The hope was that the alewife population would naturally recover, but this simply has not happened. Fish like king salmon survive on a very selective diet of alewife and smelt. When both of these species took a population dive, the fishing success on Lake Huron soon followed.

These days Lake Huron is recovering, but the king salmon fishing is still only a fraction of what it once was. The bright spot in Lake Huron is not with king or even coho salmon, but yet another salmonid species.

Stocking efforts on Atlantic salmon in Lake Huron have enjoyed significant success thanks in part to the fact that Atlantic salmon have a much wider

dietary interest than other salmon. Isolated but important Atlantic salmon fisheries have popped up in various ports around Lake Huron. Hands down the most noteworthy of these fishing destinations is the region where the St. Mary’s River dumps into northern Lake Huron near the town of DeTour, Michigan.

In May, June and early July anglers can expect to not only catch Atlantic salmon, but they have a good chance of catching a world-class trophy. A stocking program put forth by the Lake Superior State University Aquatic Research Lab has created a noteworthy fishery where none had previously thrived.

LAKE ERIE

The fishing on Lake Erie is currently so good you can toss a dead cat in any direction and find great fishing for walleye. One of the more unique fisheries in Lake Erie supports a mixed bag of both walleye and steelhead.

From the port of Wheatley to Erieau on the Ontario side of the lake, deep enough water can be found to support rainbow trout (steelhead) in significant numbers. Planted by the Ohio and Pennsylvania DNR, these steelhead feed on smelt that stack up along the north shore in late July through early September.

Anglers who visit this region of Lake Erie will catch all the walleye they want by targeting the top 30 feet of the water column. For steelhead, anglers will need to fish a little deeper along the thermocline averaging 40 to 50 feet down over 65 to 70 feet of water.

This region of Lake Erie is the only place in the Great Lakes that routinely finds anglers catching a daily limit of walleye (six per person) and rainbows (five per person) on a typical trip! As always, see your local DNR regulations for catch limits.

LAKE ONTARIO

Everything that Lake Michigan used to be is currently the situation on Lake Ontario. Being positioned at the bottom of the Great Lakes chain, nutrients from all the Great Lakes and Great Lakes connecting waters pour into Lake Ontario creating a body of water that is rich in forage and also rich in game fish species.

Stocking efforts on Lake Ontario are aggressive and include king and coho salmon, rainbow trout and brown trout. In addition, a healthy native population of lake trout and the odd Atlantic salmon round out the catch.

All of Lake Ontario could be described as great salmon fishing water, but a couple of ports are exceptional. The waters near the mouth of the Niagara River and the famed Niagara Bar rank near the top for anyone who is targeting king salmon and lots of them.

This iconic piece of structure attracts forage fish from May through the month of September and king salmon are rarely far from this feeding bonanza. Anglers who troll in an east and west pattern along the Niagara Bar are routinely rewarded with 20 fish days! Because the king salmon population on Lake Ontario is far greater than Lake Michigan, the average fish caught is smaller. However, fish in the mid to upper 20 pound range are common with a few king salmon being caught every summer that top that magic 30 pound barrier.

SUMMING IT UP

The Great Lakes are alive and well. While fisheries change as time marches on, the sport fishing opportunities available in the Great Lakes are still the crown jewels of North America. For the angler who not only likes world class fishing, but world class travel and adventure, taking on all five Great Lakes in a single season is a goal worthy of any ambitious angler.

THE AWESOME CRAPPIE BOARD IS JUST PLAIN AWESOME



Pro Staffer Rob Barnes is a walleye tournament professional who enjoys using the Awesome Crappie Board when trolling light gear and lines for walleye.

BY: ROB BARNES

For anglers that are interested in trying out open water trolling for the first time I always introduce them to the OR38 Awesome Crappie Board. Why? Simply stated, it is a small board that packs big value! Here are a few reasons I believe the Awesome Crappie Board is just plain “Awesome”.

VERSATILITY

The Awesome Crappie Board allows multi-species anglers to fish either side of the boat by simply reversing the bracket to the other side of the board. I have found that this can be done in under 10 seconds with no tools.

UTILITY

This board is small in size but big in features. Multiple boards can be packed away into small tackle boxes, saving precious storage space in smaller boats. From pulling wobbling plugs out to the side of the boat in moderate river currents for salmon and trout to trolling Off Shore Tackle’s OR36 Tadpole Resettable Diving Weights and spinners for

walleye, this unique board has a surprising amount of applications!

SIMPLICITY OF USE

The OR38 is simple to use. All you need to do is set your baits back to reach the desired depth. Then simply place your main line between the OR10 release on the bracket and the OR16 Pro Clip on the tail of the Awesome Crappie Board. Once the board is on the line, send it out to the side by simply deploying more line!

PRICE

The OR38 Awesome Crappie Board is less than \$20.00 each, making it one of the most affordable boards on the market. How awesome is that? If you are new to open water trolling or are a seasoned troller looking for a small planer board which is easily packed away for storage, consider trying Off Shore Tackle’s OR38 Awesome Crappie Board.

ATTRACTOR FISHING WITH TADPOLE DIVERS

BY: MARK ROMANACK

The Off Shore Tackle OR36 Resettable Tadpole Divers are perhaps the easiest to use and most function diving device ever invented for trolling. Tadpole Divers come by their name naturally and these divers are so simple to use anyone can master them the first time they use them.

Shaped like a tadpole, the head or diving lip of the Tadpole Diver is molded into the tail and also the tow arm. A simple coast lock snap mounts to the tow arm and a second snap is attached to the tail where a host of different lures can be rigged on a short leader.

GETTING STARTED FISHING TADPOLES

Getting started is easy. Simply tie the terminal end of the fishing line to the provided snap, add a 48 to 72 inch leader to the back of the Tadpole and the lure of your choice. Tadpoles work great for fishing nightcrawler harnesses, trolling spoons, in-line spinners and

shallow diving crankbaits.

When putting the Tadpole in the water look to be sure the snap slides up to the elbow in the tow arm. At this point, simply play line off the trolling reel to get the Tadpole diving. Some basic depth diving data for the Tadpole Diver 1, 2, 3 and Magnum sizes is available on the Off Shore Tackle website. (For a complete dive curve for the Tadpole Divers that includes various trolling speeds, consult the Precision Trolling Data, LLC phone app available at both the Apple App Store and Google Play).

WHEN A FISH IS HOOKED

When a fish is hooked trolling with a Tadpole Diver, the snap on the tow arm slides to the forward position. This converts the Tadpole Diver into an in-line weight that is no longer diving. This simple, functional and intuitive feature makes using Tadpole Divers the obvious choice for a wide range of trolling applications.

USING TADPOLES WITH BOARDS

Tadpole Divers can be fished as flat lines, but one of the most effective ways to use these unique divers is in combination with in-line boards like the OR12 Side Planer, OR38 Awesome Crappie Board or the OR37 SST Pro Mag. Using Tadpole Divers in combination with in-line boards helps anglers cover more water and also to catch more fish.

USING TADPOLE DIVERS WITH ATTRACTORS

One of the cool things about the Tadpole Divers is they can easily be rigged with a host of different attractors. Using the same snap provided with the Tadpole Diver, a small attractor such as a Yakima Bait 4 inch Fish Flash or the new Add-A-Buzz can be added directly to the back of the Tadpole Diver. Attractors help the Tadpole Diver increase catch rates. Small attractors

do a great job of luring in more fish and they do not impact on the diving ability of the Tadpole Diver.

COLOR MATCHING

When using attractors in combination with Tadpole Divers it's a good idea to match the attractor color with the lure color. This makes it easier and faster to determine the most productive color combinations.

THE UNIVERSAL DIVER

The Tadpole Diver continues to be one of the best selling products at Off Shore Tackle. These simple to use and effective divers can be used with a host of different fishing tackle and at all common trolling speeds. Tadpole Divers catch everything from crappie to king salmon. No doubt this is a big reason why the Tadpole Diver is the diver of choice for so many avid anglers.

GOT FLOATS?

BY: MARK ROMANACK

Off Shore's former OR34 Mini Planer Board has been updated to a floating version called the OR38 Awesome Crappie Board. Customers who have OR34 Mini Planer Boards can convert them to floating boards by simply ordering and installing the floats. A waterproof/water resistant superglue is required for this simple job. Simply rough up to top of the board with a heavy grit sandpaper and apply glue to the bottom of the float. No sanding is needed on the float. For best results, use the Loctite Plastics Bonding System found at www.loctiteplasticsbondingsystem.com.

Adding the float allows the Mini Board to carry more weight and makes it even easier to use. The floats are available at www.offshoretackle.com.

SNAP WEIGHT BASICS AND FINE POINTS

BY: MARK ROMANACK

The Off Shore Tackle Snap Weight, aka OR20 Pro Weight System, are incredibly easy trolling sinkers to use. A Snap Weight is a trolling weight that is married to an OR16 Pro Clip. This clip can be rigged onto the fishing line thanks to rubber pinch pad jaws and a plastic pin that protrudes through the rubber pads. Simply placing the line behind the pin in the jaws of the OR16 Pro Clip ensures the Snap Weight will

stay in place until the angler reels up and removes it.

Snap Weights can be attached to the line near the lure or further up the line to avoid spooking fish in clear water. The unique features of the Snap Weight make them arguably the most useful trolling weight on the market. When a fish is hooked on a line that features a Snap Weight, the angler simply reels in the fish and weight until

the Snap Weight comes to the rod tip and is pinched off the line.

The Pro Weight System comes with an assortment of 1/2, 3/4, 1, 1 1/2, 2 and 3 ounce weights known as Guppy Weights. These unique trolling weights can be rigged on the OR16 Pro Clip by split ring or fished in-line by simply tying the main line to the Guppy Weight and adding a leader and lure to the back of the Guppy Weight.

The Pro Weight System is a convenient starter kit, but anglers can also purchase the Pro Clips and Guppy Weights separately; creating their own unique kit.

SNAP WEIGHT/GUPPY WEIGHT VERSATILITY

Another one of the reasons the Snap Weight and Guppy Weight are so

CONTINUED ON PAGE 16

WHY GREEN FLAGS?

BY: CAPTAIN JULIA DAVIS

When I troll with my Off Shore Tackle in-line planer boards, I set them up with an OR18 Snapper Release on the bracket, and the red OR16 Pro Clip on the tail of the board. The port side boards I keep the red flags on them, and the starboard side I put the green flags on them.

I'll bet you didn't even know that Off Shore Tackle offered green flags for their boards. Well, they do have them as an aftermarket item that also has the additional tension setting holes in the flag stem for fine tuning when using the Tattle Flag™ setup. Here is why I like to use them.

First and foremost, it makes it easier for my customers to remember which side of the boat they go on. Also, when we get busy catching, and there are boards laying all over the back of the boat, and we need to get the baits back in the water fast, having to stop and take a board back off, because it's on the wrong side of the boat uses up precious time. So, eliminating little problems makes using red and green flags a great help.

The second reason is, that they remind me of navigation lights. Green on the starboard side and red on the port side. Another boat traveling from the "Green Side" across my bow will have the right of way over my vessel. Sure, I don't need a green flag to tell me that, but easy visual reminders can



The option of rigging OR12 Side Planers with red or green flags may seem like a small deal, but for those who fish boards often keeping the left from the right is a big deal and makes the process of setting boards seamless.

never be a bad thing, right?

The green flags can be ordered through the Off Shore Tackle website at www.offshoretackle.com, or you can check with your nearest Off Shore Tackle retailer to see if they carry them. Some retailers carry these aftermarket flags and some don't, so be sure to ask.



OFF SHORE TACKLE

Your Leader In

Our products can used with any monofilament

Planer Boards

Model # OR38 Awesome Crappie Board



Each OR38 Awesome Crappie Board includes an OR10 release, OR16 Pro Clip, black bracket, split ring, lock nut, 6/32 x 1/2" screw, and instructions. One board...Dual Purpose....It's Reversible and runs directly off of your rod line! Ideal for several species of fish not just crappie. Don't let the size fool you.

Model # OR12L Side Planer Left
Model # OR12R Side Planer Right

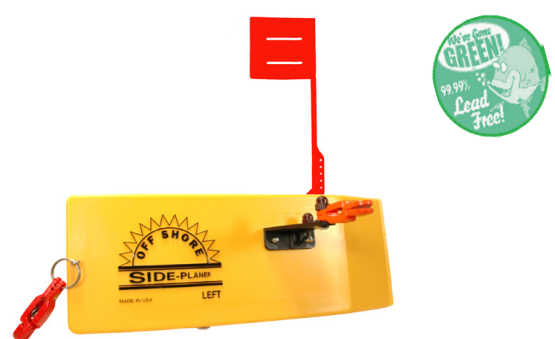

Each OR12 Side Planer includes a stationary flag, one OR19 release, one OR16 Pro Clip, instructions and is carefully ballasted to run flawlessly in rough water off of your rod line. Ideal for several species of fish.

Model # OR37L SST Pro Mag Planer Left
Model # OR37R SST Pro Mag Planer Right



The SST Pro Mag Planer includes a stationary flag, one OR18 release with lock nut, one OR16 Pro Clip, instructions and is designed to carry large, heavy baits further to the side than any other in line planer! Perfect for long copper and lead core lines. The OR16 Pro Clip on the tail of the board ensures that your board will stay on your fishing line.

Tattle Flag™ HD Upgrade Kit

Model # OR12TF Tattle Flag™ HD Upgrade Kit



Each kit includes flag, 2 OR16 Pro Clips, HD wire, spring, washer, screw eye, split ring, 6/32 screw and instructions. One kit will upgrade one OR12 Side Planer.

Model# OR12TFEK
Tattle Flag™ HD Economy Kit

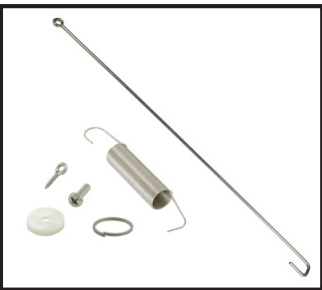

This kit works by using your OR12 Side Planer and the release/clip that came on your OR12. This kit just contains ONLY the hardware which consists of a HD wire, spring, washer, screw eye, split ring, 6/32 screw and limited instructions.

Planer Board Releases

Our three full size planer board releases come with a quickl clip for use on dual planer boards. Also available without quick clips. Their large diameter pinch pad design holds monofilament lines securely. Tensions can be adjusted further by how deeply the line is placed in the pads.

Model # OR3, OR3BWW or OR3BWOW
Light Tension Planer Board Release - White



This release is ideal for small light biting fish.

Model # OR17BWW or OR17BWOW
Medium Tension Planer Board Release - Black



This release is ideal for deep water good size fish.. It can also be used to pull lead core, snap weights and deep diving crankbaits.

Model # OR30BWW or OR30BWOW
Heavy Tension Planer Board Release - Red



This release is ideal for large lures and high speed trolling.

Model # OR18 Snapper Adjustable Tension In Line
Planer Board Release—Black

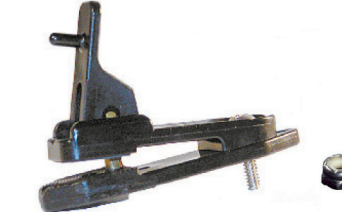

The OR18 is designed with an adjust-able cam action locking arm that can be set to release at a range of tension settings or tightened down to hold even super braid lines and lead core securely. This release comes standard on our OR37 SST Pro Mag Planer and is made to attach to the bracket of our OR12 Side Planer as well.

Model # OR39
Sam's Pro Release-Black



Manufactured by Silver Horde, the OR39 Sam's Pro Release incorporates a jettison design that allows low stretch super lines to be wrapped around a rubber plunger that in turn fits into a pressure fit housing. This release is good for all species that the super lines are ideal for.

Our three half size adjustable tension planer board releases come with quick clips for use on dual planer boards and split rings for use on in-line planer boards. They are also available without quick clips and split rings. Tension can be further adjusted by simply sliding the spring toward the pads to increase tension or away from the pads to decrease tension.

Model # OR10, OR10BWW or OR10BWOW
Adjustable Light Tension
Planer Board Release—Yellow



This release is ideal for small light biting fish.

Model # OR14, OR14BWW or OR14BWOW
Adjustable Medium Tension
Planer Board Release—Black



This release is ideal for deep water and/or good size fish as well ass most commonly used for rigging add-a-lines or fixed slider lines among downrigger anglers.

Model # OR19, OR19BWW or OR19BWOW
Adjustable Heavy Tension
Planer Board Release—Orange



This release comes as standard equipment on the OR12 Side Planer and is ideal for large lures, high speed trolling.

DON'T BE FOOLED BY IMITATIONS!

We are "Often Imitated, Never Duplicated". Make sure that when you purchase your products that they are the Original Off Shore and Riviera equipment that has proven successful and dependable! We take pride in bringing you the best!

PRODUCT SHOWCASE

Trolling Technology

line, for best results we suggest a minimum of 10 lb. test.



Pro Weights



Model # OR20
Pro Weight System



Each system includes instructions, four OR16 Pro Clips, four split rings, two of each of the following guppy weights: 1/2 oz., 3/4 oz., 1 oz., 1 1/2 oz., 2 oz., and 3 oz. all contained in a plastic tackle box. Use as Snap Weights or In Line Weights - you decide. This system is used off of flat lines, dual planer boards and side planer boards.

The OR16's and guppy weights are available to purchase separately so you can create your custom Pro Weight System!

Model # OR16, OR16BWW or OR16BWOW
Pro Clip—Red



This half size clip has an extra heavy spring tension and includes a split ring. They are also available without the split rings. You simply position your fishing line behind the pin that protrudes through the center of the pads to hold your snap weight securely on the line.

The OR16 comes as standard equipment on the tail of the OR37 SST Pro Mag Planer, OR12 Side Planer, OR38 Awesome Crappie Board and in our OR20 Pro Weight System. It is ideal for use with snap weight fishing, super braid lines and with our tattle flag™ HD system.



Replacement Pro Guppy Weights

Model # OR20 1/2
1/2 Ounce Pro Guppy Weight

Model # OR20 3/4
3/4 Ounce Pro Guppy Weight

Model # OR20 1
1 Ounce Pro Guppy Weight

Model # OR20 1 1/2
1 1/2 Ounce Pro Guppy Weight

Model # OR20 2
2 Ounce Pro Guppy Weight

Model # OR20 3
3 Ounce Pro Guppy Weight

These items, replacement parts, and promotional items (including apparel) are all available through our website. PLEASE VISIT US AT . . .

www.offshoretackle.com

★ SHOP ANYTIME ON-LINE . . . CONVENIENT & SECURE ★

Resettable Diving Weights



Model # OR36 1
Tadpole Size 1

Model # OR36 2
Tadpole Size 2

Model # OR36 3
Tadpole Size 3

Model # OR36 MAGNUM
Tadpole MAGNUM Size

Downrigger Releases

Our downrigger releases are all full size and therefore have the large diameter pinch pad design that holds monofilament lines securely. Tension can be adjusted further by how deeply the line is placed into the pads.

Model # OR4
Light Tension Single
Downrigger Release, White



This release is ideal for light biting fish.

Model # OR1
Medium Tension Single
Downrigger Release, Black



This release is ideal for deep water and/or good size fish.

Model # OR8
Heavy Tension Single
Downrigger Release, Red

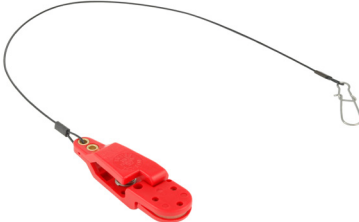

This release is ideal for large lures and high speed trolling.

Model # OR7
Light Tension Stacker
Downrigger Release, White



This release is ideal for small light biting fish and allows you to run two lines off of the same downrigger.

Model # OR2
Medium Tension Stacker
Downrigger Release, Black



This release is ideal for deep water and/or good size fish and allows you to run two lines off of the same downrigger.

Stacker Stripper/Weight Retriever

Model # OR6
Stacker Stripper/Weight Retriever

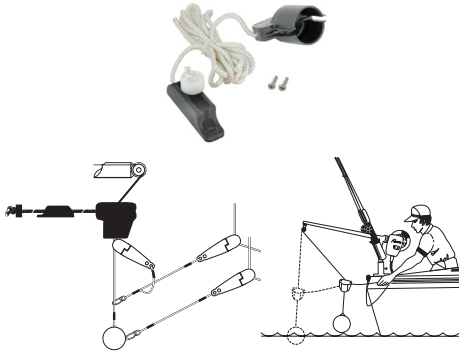

Stacking two lures on a downrigger is quicker and easier with the OR6 Stacker Stripper.

As the weight is raised, the Stripper will automatically strip the stacker release from the cable so you won't have to stop the cannonball. The automatic stripping eliminates the grooves worn into stacker pads from sliding on the cable.

The OR6 doubles as a Weight Retriever to bring the weight into the boat for resetting lines. Using the retriever cord will reduce damaging cannonball sway.

Replacement Pads

Model # ORRP8
Replacement pads for OR1, OR2, OR3, OR4, OR7, OR8, OR17, and OR30 releases.



Model # ORRP8SN
Replacement pads for OR18 releases.



Model # ORRP16
Replacement pads for OR10, OR14, and OR19 releases.



Model # ORRP16HL
Replacement pads for OR16 clips.

EZ Crankbait Tuner

Model # OR40
EZ Crankbait Tuner



These unique tuning pliers feature a long and short jaw design that includes an adjustable spring tension setting making it possible to tune any crankbait.

THE LINE LOOP TRICK

BY: MARK ROMANACK

The OR12 Side Planer and the OR38 Awesome Crappie Board are two of the most popular planer boards in the nation. Anglers coast to coast are catching just about everything that swims using these boards. One of the things that anglers like best about these boards is they come factory equipped with functional and popular line releases and clips.

The OR12 Side Planer comes factory supplied with an OR19 Adjustable Heavy Tension Planer Board Release (orange) on the bracket of the board and the OR16 Pro Clip (red) mounted to the tail of the board. Rigged in this manner the OR12 is ideally set up for anglers



Dale Voice used the “loop trick” to land this beautiful rainbow from Elk Lake in Northern Michigan.

who troll using monofilament, co-polymers or fluorocarbon line types.

The OR38 Awesome Crappie Board comes factory supplied with an OR10 Adjustable Light Tension Release (yel-

low) on the bracket of the board and an OR16 Pro Clip (red) on the tail of the board. Here again, this factory rigging option is ideal for fishing monofilament, co-polymer lines or fluorocarbon line.

THE STANDARD RIGGING OPTION

The standard way that anglers rig up both of these popular boards involves letting the desired lure out behind the boat. The next step is to grab the board in one hand and the fishing line in the other. Next pinch open the line release on the bracket of the board and place the fishing line between the rubber pads near the back of the release. To finish the rigging, pinch open the OR16 clip at the tail of the board and place the fishing line behind the plastic pin that is protruding through the middle of the rubber pinch pads.

Rigged in this manner, the board is dropped in the water and more line played off the reel until the board is presented the desired distance out to the side of the boat. This process can be repeated running two, three, four or even five board lines per side of the boat (just check your DNR regulations for limits)!

When a fish strikes and is hooked, the board will be pulled backwards in the water from the weight of the struggling fish. By grabbing the rod, reeling down tight against the board and giving the rod tip a sharp snap, the line can be tripped free from the bracket release. When the line is tripped from the bracket release, the board swings around in the water and is no longer planing out to the side. Meanwhile, the board remains pegged to the line thanks to the line being properly secured in the OR16 Pro Clip at the tail of the board.

Depending on the size of fish and also

the trolling speed, it might take a couple tries to snap the line free of the bracket release.

THE LOOP TRICK

Those who are looking for a rigging method that makes it easier to trip the line from the front release will want to try the “loop trick” rigging method. The “loop trick” works flawlessly with monofilament, co-polymer and fluorocarbon line types.

After setting the lure the desired distance behind the boat, grab the fishing line near the rod tip and fold the line over your index finger. Spin your finger a few times to create a loop of line with several twists. Open the line release on the bracket of the board and place these twists of line between the rubber pads.

Ideally you want a loop of line about one inch long sticking out of the planer release. Next grab the line again, pinch open the OR16 Pro Clip on the tail of the board and place the line behind the plastic pin.

Rigged in this manner the board can be played out to the side the desired distance. When a fish strikes and the board is being pulled backwards in the water, the angler once again grabs the rod, reels down until the weight of the board and fish can be felt and then gives the rod a quick snap. This motion will smoothly trip the loop of line free from the bracket release with far less pressure than the standard rigging method.

Of course, once the line is released from the bracket, the board spins around in the water but remains pinned in place thanks to the OR16. The “loop trick” rigging method is dependable, easy to rig and a slick way to run, two, three, four, five or more lines per side of the boat. This unique rigging method allows

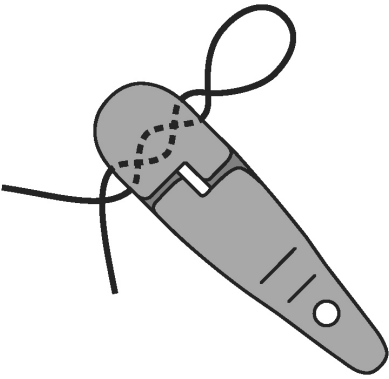

anglers to easily trip their board when a fish strikes or when it’s time to switch out lures.

The loop trick can be adapted to any species, trolling speed or trolling strategy so long as the main line or backing line (if using lead core or sinking line setups) is either monofilament, co-polymer or fluorocarbon line types.

TROUBLE SHOOTING

On occasion a board rigged using the loop trick can’t be tripped by simply popping the rod tip. In this case, chances are the loop of line was a little too long and that loop has snagged over the small plastic nut that holds the release on the bracket of the board. Be sure when using the “loop trick” to pull up the loop so that no more than about one inch of line protrudes past the rubber pads on the line release.

MORE TIPS

The “loop trick” rigging method works with all of the adjustable planer board releases produced by Off Shore Tackle including the OR10, OR14 and OR19 releases. It’s best when using the “loop trick” to keep these releases set in the heaviest tension position. This is accomplished by using a small screw driver blade to slide the spring in the release to the forward position toward the pads.

MORE USES FOR THE OR18 SNAPPER RELEASE

BY: JAKE ROMANACK

If you’re like me, chances are you share a boat often with some novice anglers. The best way to learn about fishing is the hands-on approach, but that also means that inexperienced anglers are going to make mistakes, sometimes costly mistakes.

Recently while fishing with a group of buddies, it was pretty rough on the big pond. It was rough enough that our only option was to troll with the wind in a following sea. Our goal was to make one very long pass, catch as many fish as possible and then get out of dodge before the waves got any bigger.

We were trolling crankbaits using the OR12 Side Planer boards with the standard release/clip they come with. The OR19 (orange) line release is attached to the bracket of the board and the OR16 (red) Pro Clip I move from the secured mounted location on the tail of the board to the Tattle Flag™ wire on the back of the board on the split ring (I converted the boards into Tattle Flag™ boards by purchasing the OR12TFEK Tattle Flag™ HD Economy Kits which just supplies the hardware and HD wire). This setup is designed to function flawlessly when using monofilament, co-polymer or fluorocarbon lines.

Rigged in this manner the main line can be tripped free of the OR19 bracket release when a fish is hooked, yet the board remains pegged to the line thanks to the OR16 Pro Clip hanging off of the Tattle Flag™ wire on the back of the board. The OR16 Pro Clip features a plastic pin protruding through the middle of the rubber pinch pads. When the clip is opened and the line is placed behind this pin, the planer board is fixed on the line. When the line is popped free of the

OR19, the board spins around in the water and is no longer planing out to the side of the boat.

This rigging method is fundamentally important because it allows boards to be tripped and reeled in easily for switching out lures, changing lead lengths and of course for fighting fish. Rigged in this fashion an angler can fish two, three, four or even more board lines per side of the boat (based on your local DNR regulations of course) without having to ever clear a line to reel in a board. Slick!

The only fly in the ointment is that to function properly the line must be placed behind the pin on the OR16 Pro Clip. The tension on this unique line clip is pretty stout and many anglers struggle to open the clip up far enough to get the line behind the pin. When the line isn’t placed behind the pin, the board can pop completely off the line when the line is tripped from the bracket release setting the board to drift!

In most cases if a board pops off the line due to “operator error” it’s no big deal. Simply turn the boat around and go back to recover the lost board. In this particular situation rough water was making it impossible to turn around and recover a lost board.

After watching a couple of my prized OR12 Side Planers drift away, I struck onto a solution to this problem. I removed the OR16 Pro Clip from the back of my boards and replaced it with an OR18 Snapper Release. The Snapper is a cam operated line clip that features a screw adjustment setting. Once the line is in between the pads and the cam jaws are locked closed, the fishing line is held firmly in place. No amount of



Off Shore Tackle Pro Staffer Jake Romanack uses the OR18 Snapper Release on the back of his OR12 boards to insure he never finds himself chasing boards. Easy to use and 100% positive, the Snapper Release can be used on both super lines and monofilament.

operator error can prevent the OR18 Snapper from functioning as designed!

While the OR18 was designed for anglers who troll using super lines, this unique clip can also be used with other line types. In fact, the Snapper Release is the only line release/clip that can be used with all line types.

The next time you find yourself fishing with rookies and dropping boards all across America, consider adding a Snapper Release to the tail of your OR12 Side Planers. This simple step just about guarantees you won’t be losing boards or yelling at your buddies for not hitching up the boards correctly in the first place.

Be prepared when you hit the water – purchase your Off Shore Tackle Company LLC products at your local dealer or send in your order today!

Prices in effect January 1, 2020 through December 31, 2020



Order Blank

MODEL NUMBER	DESCRIPTION	UNIT PACKAGE	NUMBER OF PKGS. ORDERING	PRICE	EXTENDED AMOUNT
OFF SHORE TACKLE COMPANY LLC SIDE PLANER BOARD PRODUCTS					
OR38	Awesome Crappie Board With Float	Pkg. of 1		\$19.99	
OR12L	Side Planer Left	Pkg. of 1		\$39.25	
OR12R	Side Planer Right	Pkg. of 1		\$39.25	
OR12P2	Pigtail and Split Ring For OR12L and OR12R	Pkg. of 2		\$3.85	
OR12TF	Tattle Flag™ HD Upgrade Kit	Pkg. of 1		\$27.10	
OR12TFEK	Tattle Flag™ HD ECONOMY KIT (No Release/Clip or Flag Included)	Pkg. of 1		\$9.99	
ORS2	Tattle Flag™ Replacement Spring	Pkg. of 2		\$7.75	
OR37L	SST Pro Mag Planer Left	Pkg. of 1		\$56.15	
OR37R	SST Pro Mag Planer Right	Pkg. of 1		\$56.15	
OFF SHORE TACKLE COMPANY LLC PLANER BOARD					
OR3	Light Tension, White With Quick Clip (Bulk 50 Packs Available Through Our Website)	Pkg. of 2		\$16.00	
OR17BWW	Medium Tension, Black With Quick Clip (Available Without Quick Clip Through Our Website)	Pkg. of 24		\$182.50	
OR30BWW	Heavy Tension, Red With Quick Clip (Available Without Quick Clip Through Our Website)	Pkg. of 6		\$54.85	
OR18	Snapper Adjustable Tension, Black With Lock Nut	Pkg. of 1		\$15.60	
OR10	Adjustable Light Tension, Yellow With Split Ring and Quick Clip (Bulk 100 Packs Available Through Our Website)	Pkg. of 4		\$22.50	
OR14	Adjustable Medium Tension, Black With Split Ring and Quick Clip (Bulk 100 Packs Available Through Our Website)	Pkg. of 4		\$22.50	
OR19	Adjustable Heavy Tension, Orange With Split Ring and Quick Clip (Bulk 100 Packs Available Through Our Website)	Pkg. of 2		\$11.60	
OR39	Sam's Pro Release, Black With Split Ring and Lock Nut	Pkg. of 1		\$13.99	
OFF SHORE TACKLE COMPANY LLC PRO SNAP WEIGHT PRODUCTS					
OR20	Pro Snap Weight System	Pkg. of 1		\$50.25	
OR16	Heavy Tension Pro Clip, Red With Split Ring (Bulk 100 Packs Available Through Our Website)	Pkg. of 2		\$13.45	
OR20 1/2	1/2 Ounce Replacement Pro Guppy Weight	Pkg. of 3		\$4.75	
OR20 3/4	3/4 Ounce Replacement Pro Guppy Weight	Pkg. of 3		\$5.25	
OR20 1	1 Ounce Replacement Pro Guppy Weight	Pkg. of 3		\$6.25	
OR20 1 1/2	1 1/2 Ounce Replacement Pro Guppy Weight	Pkg. of 2		\$4.75	
OR20 2	2 Ounce Replacement Pro Guppy Weight	Pkg. of 2		\$5.65	
OR20 3	3 Ounce Replacement Pro Guppy Weight	Pkg. of 1		\$3.95	
OFF SHORE TACKLE COMPANY LLC RESETTABLE DIVING WEIGHTS					
OR36 1	Tadpole Size 1 – Includes Two Coast Lock Snaps	Pkg. of 1		\$7.30	
OR36 2	Tadpole Size 2 – Includes Two Coast Lock Snaps	Pkg. of 1		\$7.55	
OR36 3	Tadpole Size 3 – Includes Two Coast Lock Snaps	Pkg. of 1		\$12.87	
OR36 MAGNUM	Tadpole MAGNUM Size – Includes Two Coast Lock Snaps	Pkg. of 1		\$12.99	

Continued on reverse



These items, replacement parts, and promotional items are available through our website:
www.offshoretackle.com



★ SHOP ANYTIME ON-LINE . . . CONVENIENT & SECURE ★

Be prepared when you hit the water – purchase your Off Shore Tackle Company LLC products at your local dealer or send in your order today!



Prices in effect January 1, 2020 through December 31, 2020



ORDER BLANK CONTINUED FROM PRIOR PAGE

MODEL NUMBER	DESCRIPTION	UNIT PACKAGE	NUMBER OF PKGS. ORDERING	PRICE	EXTENDED AMOUNT
OFF SHORE TACKLE COMPANY LLC SINGLE DOWNRIGGER RELEASES					
OR4	Light Tension, White	Pkg. of 1		\$9.95	
OR1	Medium Tension, Black	Pkg. of 1		\$9.95	
OR8	Heavy Tension, Red	Pkg. of 1		\$14.00	
OFF SHORE TACKLE COMPANY LLC STACKER DOWNRIGGER RELEASES					
OR7	Light Tension, White	Pkg. of 1		\$16.20	
OR2	Medium Tension, Black	Pkg. of 1		\$16.20	
OFF SHORE TACKLE COMPANY LLC STACKER STRIPPER/WEIGHT RETRIEVER COMBINATION					
OR6	Strips The Stacker Release Off Of The Downrigger Cable As The Weight Is Raised. Also Doubles As A Weight Retriever By Pull Cord. Line Loc Included.	Pkg. of 1		\$13.83	
OFF SHORE TACKLE COMPANY LLC REPLACEMENT PADS					
ORRP8	Pads For OR1's, OR2's, OR3's, OR4's, OR7's, OR8's, OR17's, and OR30's	Pkg. of 8		\$3.60	
ORRP8SN	Pads For OR18's	Pkg. of 8		\$8.50	
ORRP16	Pads For OR10's, OR14's, and OR19's	Pkg. of 16		\$4.60	
ORRP16HL	Pads For OR16's	Pkg. of 16		\$6.20	
OFF SHORE TACKLE COMPANY LLC OTHER ACCESSORIES					
OR40	EZ Tuning Tool, Black With Lanyard	Pkg. of 1		\$22.99	

Prices and packaging subject to change without notice.



These items, replacement parts, and promotional items are all available through our website:

www.offshoretackle.com

★ SHOP ANYTIME ON-LINE . . . CONVENIENT & SECURE ★

Product Total

Shipping Charges Within The 48 Mainland United States

Subtotal
(Product Total Plus Shipping Charges)

Michigan Residents and Orders Being Shipped to a Michigan Address from Non Residents, Add 6% Sales Tax Based On Subtotal

Total (Subtotal Plus Sales Tax)
U. S. Funds Enclosed

★ ONLY ACCEPTING ORDERS BEING SHIPPED TO AN ADDRESS WITHIN THE U.S.A. ★

\$8.99

Send THIS completed order form, along with your U.S.P.S. money order or COMPLETE credit card information to:
Off Shore Tackle Company LLC, P.O. Box 88, Port Austin, MI 48467-0088
Please allow 2-3 weeks for delivery.

MAILING ADDRESS (Check here _____ if this is an address change):

Name: _____

c/o: _____

Address: _____

City: _____ State: _____ ZIP: _____

Telephone: (_____) _____ - _____

E-Mail Address: _____

SHIP ORDER TO (Must have street address for UPS/FedEx delivery):

Name: _____

c/o: _____

Address: _____

City: _____ State: _____ ZIP: _____

Telephone: (_____) _____ - _____

How did you hear about us? _____

Please check:
____ Residence
____ Work
____ Other

Your mailing address MUST match the address that your credit card bill is mailed to – no exceptions.

Please check: To charge your order on your MasterCard or Visa, enter your credit card number, expiration date, card ID number and sign below, or call 989-738-5600.

____ MasterCard Number _____ Exp. Date: _____ ID Number: _____

____ Visa Signature _____

(ID Number is usually located on the backside of your MasterCard or Visa after your credit card number [3 Digit Code]).

Riviera Product Showcase



Dual Planer Board Masts

Kachman Automatic Retrieval Reels With Collapsible Aluminum Mast, Base, Deck Plate and Four Hold Down Knobs (Shown right)

Unit Includes:

- Aluminum Pulley Brackets
- 7' Collapsible Aluminum Black Powder Coated Mast
- Nylon Mounting Bracket
- Kachman Automatic Retrieval Reels
- 150' Fluorescent Orange 200# Planer Line On Each Reel Multidirectional Pulleys
- Stainless Steel Guide Bushings
- Two OR10 Adjustable Light Tension Planer Board Releases



This Unit Is Available in Different Base Options

Model # DPMKA
Has The Regular Base

Model # DPMKSA
Has the Springfield Taper-Lock Seat Mount

Model # DPMKSLA
Has The Springfield Spring-Lock Seat Mount

Model # DPMKSUA
Has The Springfield Uni-Lock Seat Mount

Model # DPMKSZA
Has The Attwood Swivl-Eze 2 3/8" Seat Mount

Aluminum Manual Retrieval Posi-Stop Reels, Collapsible Mast, Base, Deck Plate and Four Hold Down Knobs (Shown right)

Unit Includes:

- Aluminum Pulley brackets
- 7' Collapsible Aluminum Black Powder Coated Mast
- Nylon Mounting Bracket
- Aluminum Manual Posi-Stop Retrieval Reels
- 150' Fluorescent Orange 200# Planer Line On Each Reel
- Multidirectional Pulleys
- Stainless Steel Guide Bushings
- Two OR10 Adjustable Light Tension Planer Board Releases



This Unit Is Available in Different Base Options

Model # DPMPA
Has The Regular Base

Model # DPMPSA
Has The Springfield Taper-Lock Seat Mount

Model # DPMPSLA
Has The Springfield Spring-Lock Seat Mount

Model # DPMPSUA
Has The Springfield Uni-Lock Seat Mount

Model # DPMPSZA
Has The Attwood Swivl-Eze 2 3/8" Seat Mount

Base Options



Swiveling Rod Tower

This unit incorporates our swiveling base that allows the tower to swivel and lock up every 90 degrees with easy removal of the tower by simply pulling out a spring loaded pin and lifting. Unit is made of black powder coated aluminum for durability with all rod holders being adjustable in 15 degree increments. Tower can be used on both port and starboard sides!

Model # SRT3
Has 3 Adjustable Rod Holders

Model # SRT4
Has 4 Adjustable Rod Holders

Model # SRT5 (Shown)
Has 5 Adjustable Rod Holders

Model # SRT6
Has 6 Adjustable Rod Holders

Model # SRTRH
Extra Rod Holder With Indexing Bracket

Model # SRTTA
Track Adapter For SRT That Fits Most Tracks

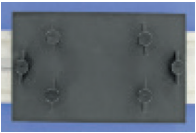

Track Mount For RCPK And RCWIRE

Model # TM
Track Mount



This 6" track permanently mounts to your, gunwale, hard top, fly bridge or radar arch of your boat. The RCPK or RCWIRE is mounted to the track's adapter and is easily put into use or removed.



Planer Board Rail Clamp Mounts

Model #RCPK
Kachman Automatic Retrieval Reels With Rail Clamp Mount

Unit Includes:

- Kachman Automatic Retrieval Reels
- 150' Fluorescent Orange 200# Planer Line
- Aluminum Clamp Bracket That Fits 3/4" to 1 1/4" Rails



Model #RCPP
Aluminum Manual Retrieval Posi-Stop Reels

Unit Includes:

- Aluminum Manual Retrieval Posi-Stop Reels
- 150' Fluorescent Orange 200# Planer Line
- Aluminum Clamp Bracket That Fits 7/8" to 1" Rails

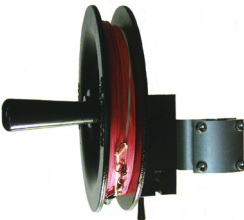

Dual and Triple Planer Boards

Model # DPB
Dual Planer Board—Collapsible For Easy Storage



Model # TPB
Triple Planer Board—Collapsible For Easy Storage



The DPB's and TPB's are used in conjunction with a mast system. They are ballasted so the nose is slightly raised to cut through the waves easier and have a 3 position tow point to allow you to adapt to different water conditions instantly. To store, simply fold the outside board forward. Each board can be used on either port or starboard. A sample Planer Board Release comes with each DPB and TPB.

Hand/Wire Line Reels



Model # RCWIRE
Kachman Automatic Retrieval Hand Line Reel Kit

Unit Includes:

- Kachman Automatic Retrieval Reel
- 200' Coated 60# Wire With Snap Swivel Termination
- 5' Pro Shank
- Aluminum Clamp Bracket That Fits 3/4"-1 1/4" Rails
- Tempress Rod Holder Adapter Replacement Parts Available

Model # WGHT
1 1/4 Pound Weight

Model # SHNK
5' Pro Shank

SNAP WEIGHT BASICS AND FINE POINTS CONTINUED FROM PAGE 9

BY: MARK ROMANACK

popular is their versatility. These trolling weights can be used in combination with a wide variety of popular trolling lures such as spoons, in-line spinners, crankbaits and also live bait rigs like crawler harnesses. These unique trolling sinkers see a lot of service among walleye anglers, but they can also be used to troll for steelhead, salmon, brown trout and lakerearly in the season when these fish inhabit shallow water.

SNAP WEIGHTS AND CRANKBAITS

Snap Weights are often used in combination with crankbaits to get these lures to deeper depths. Some years ago, Precision Trolling Data tested a one-ounce Snap Weight in combination with a host of different crankbait models and types.

Letting the crankbait out 20 feet, adding a one ounce Snap Weight to the line and then letting out an additional 100 feet of line (a total lead length of 120 feet) will cause most floating/diving style crankbaits to pick up about 30% more diving depth. Say for example a crankbait will dive 15 feet when set 120 feet back, adding the one ounce Snap Weight increases the diving depth to 20 feet or about 30% deeper.

This handy doing the math in your head method for achieving a modest amount of additional depth from crankbaits has become known as the 20 Plus Method. Recently Precision Trolling Data released a new option for achieving even more accurate depth diving

data from popular crankbaits. Even better, PTD does the math for you! Known as the 50 Plus 2 Method, this system involves specific models of crankbaits tested using a series of specific lead lengths, trolling speeds and also a two-ounce size Snap Weight. The two-ounce Snap Weight is overwhelmingly the most popular size used among anglers who troll to increase the diving depth of crankbaits.

Here’s how the 50 Plus 2 System works. Click the “line type” option on the PTD phone app to see if the lure in question has been tested using the 50 Plus 2 Method. If a lure has been tested

with this system in the line type option it will read “10# Berkley XT/50 Foot Leader and 2 Ounce Snap Weight”.

Baits that have been tested with the two ounce Snap Weight require letting the lure out a set lead length of 50 feet then attaching a two ounce Snap Weight onto the line. Once the Snap Weight is attached to the line, play out additional lead known as the “dropper lead” to achieve added depth. The “feet



back” picker wheel on the app will tell you how much total lead length to play out to achieve the depths listed on the “feet down” picker wheel. This data has also been tested using multiple trolling speeds making it by far the

most accurate method available for determining how deep crankbaits will dive when using a two-ounce Snap Weight.

Collectively, the 50 Plus 2 Method is the most sophisticated depth data ever produced by Precision Trolling. Using this system anglers can literally double the depth of popular crankbaits, use

shorter lead lengths to achieve target depths and also troll with confidence knowing precisely where their valuable lures are running in the water column.

The first release of data in the 50 Plus 2 Method involved 16 popular crankbait models. Subsequent releases will include more lures each year. To see a list of lures included in the 50 Plus 2 Method, visit the www.precisiontrollingdata.com web page. If the lure

or lures you troll most often are not included in the 50 Plus 2 Method send a short note to PTD requesting this data. The lures that get tested for the PTD app are determined by popular demand from customers who regularly use the app.

THE 50-FOOT LEAD

Many anglers have asked why Precision Trolling Data decided to use a fixed 50 foot lead when testing the two ounce Snap Weight. After interviewing dozens of the top professional anglers on the National Walleye Tour, it was the opinion of most of these trolling experts that a longer leader would serve them best in all trolling situations.

These days the waters most commonly fished for walleye are becoming clearer and clearer each year. Evasive species like the zebra and quagga mussels have populated literally every popular walleye fishery in the Great Lakes basin and many beyond. These mollusks are siphon feeders that filter plankton from the water, creating clearer waters in their wake.

Using a longer 50-foot leader creates a stealthier trolling approach, especially when faced with clear water environments.

SUMMING IT UP

Snap Weights are easy to use, effective and the most versatile in-line trolling weight on the market. It’s easy to see why the Snap Weight is the king of in-line trolling sinkers.

TROLLING CAN BE A DRAG - LOL

BY: GARY PARSONS AND KEITH KAVAJECZ

Crankbaits trolled to the right depth are critical to fishing success. When fishing on structure that might mean getting the bait super close to the bottom – in open water it will mean getting the bait the right distance above suspending walleye looking to feed in an upward direction. In either case, there are a couple of factors that you can control to get the cranks in the strike zone.

Working with the Precision Trolling crew over the last few years has quantified factors that can affect how deep a crankbait can dive. One might think that just letting out more line would make the bait go deeper and deeper. Quite to the contrary – every crankbait has a maximum dive depth, and then water resistance (or drag) impedes the bait from going deeper. Let’s look at a couple of factors that put a drag on trolling.

Every crank has a maximum depth and a dive curve to achieve that depth. Baits dive quickly at first, but then the progress slows as more line is let out. This is due to drag and friction created by the line. As most anglers know, thinner line will allow a crankbait to dive deeper. If you look in the Precision Trolling Data app, a good example is a Berkley #9 Flicker Minnow. It will

dive to 18 feet deep with 100 feet of 10# Berkley XT. Deploy that same bait using thinner 10# Berkley Fireline and 100 feet will get the bait to 22 feet.

One interesting factoid is that trolling speed makes very little difference on the diving depth of a crank. At higher speeds it might feel like the bait is digging harder (and therefore you would assume deeper), but the extra speed also increases the water resistance on the line and negates any extra dive depth. Cranks will run within inches of the same depth trolling any speed from about 1.5mph up to 3 mph.

One often asked question about dive depths is how much will an in-line planer board like the Off Shore Tackle OR12 affect the dive depth. Actually, the planer board has no influence on how deep the crankbait will run. The board will simply change the path (spread to the side) that the lure is traveling.

When running an Off Shore board, remember to look at the Precision Trolling App for the amount of line to let out to reach a particular depth. Then attach the Off Shore board. Since the board is right at water level, it is the perfect place for the line to start to achieve the depth listed in the app.

One important place speed does mat-

ter is with weighted systems like Off Shore Tackle OR20 Pro Weights used as Snap Weights (OR16 Pro Clip with a Pro Guppy Weight attached by a split ring) and Off Shore Tackle OR36 Tadpoles. These “sinking devices” have a significant amount of drag in the water, so speed will affect their ability to dive. Let’s look in the app at some “50+2” data and see how speed matters. “50+2” refers to a system where you put out a 50 foot leader of 10# XT (or line with equivalent diameter) then add a 2 oz Snap Weight. After that you let out the amount of “dropper” line needed to get to the desired depth.

So let’s use a #7 Berkley Flicker Shad as an example. First go to the Berkley category and select the #7 Flicker Shad. Switch the line type to “10# Berkley XT / 50ft Leader 2oz Snap Weight” – this is the 50+2 data. Next scroll down the Feet Back wheel to 50. Notice at 50 it reminds you that this is where the Snap Weight (SW) is added. The app always shows the total amount of line out including the 50 foot leader.

Now scroll down to 80 feet. Some anglers (including us) would use the terminology 50+2+30 (50 foot leader, 2 oz Off Shore Snap Weight, 30 foot dropper, total of 80 feet). Now move the MPH wheel to 1.5 mph. Notice

that this setup will bring a 7 Flicker Shad down to 24 feet. Now bump up the speed wheel to 2 mph – the depth decreases to 21 feet – that’s due to the extra drag being put on the 2oz Off Shore Snap Weight. Now bump up to 2.5 and you will again see the depth decrease down to 18 feet.

This decrease in depth when you increase speed will happen with any weighting system – OST Snap Weights, Tadpoles, and even lead core line. This is why a speed wheel is given in the app only when using a weighted or negatively buoyant trolling system.

Even though the line and trolling devices may cause a “drag” in your setup, by paying attention to line length and speed (when weighted systems are employed) you can get your cranks to the right depth. Getting your crankbait depth dialed in often results in walleye success and The Next Bite!

Editor’s Note: Gary Parsons and Keith Kavajecz are tournament professionals, Hall of Fame anglers, legends in walleye fishing and the founders of the popular TV series The Next Bite as well as long time Pro Staffers for Off Shore Tackle.

DISCLAIMER

Product features, opinions, and/or individual’s contact information may have changed since these articles were originally composed.

PLEASE NOTE

Before using any fishing/rigging method, make sure to consult your local Department of Natural Resources fishing directory to confirm local fishing regulations.

Be prepared when you hit the water – purchase your Riviera Trolling Systems products
at your local dealer or send in your order today!

Prices in effect January 1, 2020 through December 31, 2020



Order Blank

MODEL NUMBER	DESCRIPTION	UNIT PACKAGE	NUMBER OF PKGS. ORDERING	PRICE	EXTENDED AMOUNT
RIVIERA DUAL PLANER BOARD MASTS					
DPMKA	7' Collapsible Aluminum Black Powder Coated Mast With Kachman Automatic Retrieval Reels With Regular Base	Pkg. of 1		\$445.00	
DPMKSA	Fits With Springfield Taper-Lock Seat Mount	Pkg. of 1		\$445.00	
DPMKSLA	Fits With Springfield Spring-Lock Seat Mount	Pkg. of 1		\$445.00	
DPMKSUA	Fits With Springfield Uni-Lock Seat Mount	Pkg. of 1		\$445.00	
DPMKSZA	Fits With Attwood Swivl-Eze 2-3/8" Seat Mount	Pkg. of 1		\$445.00	
DPMPA	7' Collapsible Aluminum Black Powder Coated Mast With Manual Posi-Stop Reels With Regular Base	Pkg. of 1		\$335.00	
DPMPSA	Fits With Springfield Taper-Lock Seat Mount	Pkg. of 1		\$335.00	
DPMPSLA	Fits With Springfield Spring-Lock Seat Mount	Pkg. of 1		\$335.00	
DPMPSUA	Fits With Springfield Uni-Lock Seat Mount	Pkg. of 1		\$335.00	
DPMPSZA	Fits With Attwood Swivl-Eze 2-3/8" Seat Mount	Pkg. of 1		\$335.00	
RIVIERA SWIVELING ROD TOWER					
SRT3	With 3 Adjustable Rod Holders	Pkg. of 1		\$195.00	
SRT4	With 4 Adjustable Rod Holders	Pkg. of 1		\$240.00	
SRT5	With 5 Adjustable Rod Holders	Pkg. of 1		\$280.00	
SRT6	With 6 Adjustable Rod Holders	Pkg. of 1		\$320.00	
SRTRH	Extra Adjustable Rod Holder With Index Brackets	Pkg. of 1		\$49.00	
SRTTA	Track Adapter For SRT That Fits Most Tracks	Pkg. of 1		\$49.00	
RIVIERA TRACK MOUNT					
TM	Track Mount For RCPK or RCWIRE	Pkg. of 1		\$49.00	
RIVIERA PLANER BOARD RAIL CLAMP MOUNTS					
RCPK	Kachman Automatic Retrieval Rail Clamp	Pkg. of 1		\$189.00	
RCPP	Manual Retrieval Rail Clamp With Aluminum Black Powder Coated Posi-Stop Reels	Pkg. of 1		\$99.00	
RIVIERA DUAL AND TRIPLE PLANER BOARDS					
DPB	Dual Planer Board - Collapsible For Easy Storage	Pkg. of 1		\$77.00	
TPB	Triple Planer Board - Collapsible For Easy Storage	Pkg. of 1		\$99.00	
RIVIERA HAND LINE REELS					
RCWIRE	Kachman Automatic Hand Line Reel With Rail Clamp Mount, Wire, Weight, Shank, and Rod Holder Adapter	Pkg. of 1		\$199.00	
WGHT	1 1/4 Pound Weight	Pkg. of 1		\$6.00	
SHNK	5' Pro Shank	Pkg. of 1		\$5.00	

*SHIPPING CHARGES WITHIN THE 48 MAINLAND UNITED STATES:	MERCHANDISE TOTAL	SHIPPING CHARGE
	\$0.01 - \$15.00	\$8.00
	\$15.01 - \$30.00	\$9.00
	\$30.01 - \$50.00	\$10.00
	\$50.01 - \$80.00	\$12.00
	\$80.01 - \$100.00	\$13.00
	\$100.01 - \$200.00	\$14.00
	\$200.01 - \$300.00	\$15.00
	\$300.01 - \$400.00	\$16.00
	\$400.01 - \$500.00	\$17.00
	Over \$500.00	FREE

Product Total

*Shipping Charges

Subtotal (Product Total Plus Shipping Charges)

Michigan Residents and Orders Being Shipped to a Michigan Address from Non Residents, Add 6% Sales Tax Based On Subtotal

Total (Subtotal Plus Sales Tax) U. S. Funds Enclosed

*For orders being shipped outside of the 48 mainland United States, please call for shipping charges. Duties and taxes will be your responsibility.
Send THIS completed order form, along with your U.S.P.S. money order, check, (sorry, no out of country money orders or checks can be accepted),
or COMPLETE credit card information to:

Riviera Trolling Systems Incorporated
P.O. Box 507, Port Austin, MI 48467-0507

Orders will be released upon clearance of checks, please allow 2-3 weeks for delivery. Credit card orders are normally shipped within 5 business days of receipt of order.

MAILING ADDRESS (Check here if this is an address change): SHIP ORDER TO (Must have street address for UPS/FedEx delivery):

Please check:
Name: Residence
Work
Other

c/o:

Address:

City: State: ZIP:

Telephone: () -

E-Mail Address:

How did you hear about us?

Your mailing address MUST match the address that your credit card bill is mailed to – no exceptions.

Please check:

To charge your order on your American Express, Discover, MasterCard or Visa, enter your credit card number, expiration date, card ID number and sign below, or call 989-738-5700.

American Express
Discover
MasterCard
Visa

Number
Signature

Exp. Date:
ID Number:

(ID Number is located on the backside of your Discover, MasterCard or Visa after your credit card number [3 Digit Code]; on American Express it is located on the front of your card usually to the upper right of your card number [4 Digit Code]).

FROM THE CHAIRMAN OF THE BOARDS, BRUCE DESHANO

Another year gone by and it was filled with unusual weather. I didn't get out fishing as much as I had wanted to during 2019. High winds, high water and late spring took a toll on the time I could get on the water. However, reports from our pro staffers were good with a lot of big fish caught in Lake Erie and consistent limits on Saginaw Bay (my home water).

The Off Shore Tackle Tournament Pro Team continues to dominate the National Walleye Tour, Masters Walleye Circuit, Lake Erie Walleye Trail and others. As many of you may have heard, my dear friend and tournament pro Tommy Skarlis is battling with a brain tumor. Tommy is a winner and he is proving to be "Tommy Strong" in this battle as well!

On a personal note, after years of trying, I finally harvested my mountain lion in December of 2018 with the Whitaker Brothers (Whitaker-brothershunting.com). These are great people to hunt with and I highly recommend them.

One of our hottest new Off Shore Tackle products, is the OR40 EZ Crankbait Tuner. This unique tuning plier has become a big hit with anyone trolling or throwing cranks. Thanks to the OR40 EZ Crankbait Tuner we have been able to put crankbaits back into service we thought were un-tunable. This unique product has turned out to be a great investment in the custom crankbait market of today.

I am enjoying my "retirement" and Nick is staying busy at the helm of the family business. It is very relaxing to know Off Shore Tackle is in such good hands!

As always, I appreciate the support of our staff members working to keep Off Shore Tackle up front and the "Your Leader in Trolling Technology".



FROM THE DESK OF NICK DESHANO

Well, another great year is in the books. From tough weather in the summer of 2019, to just being busy, I didn't get on the water as much as I would have liked but made the most of what time I had. There's nothing better than spending time in the boat with family and friends. Being in the fishing industry takes a lot of actual fishing time away but I love what I do and I wouldn't change a thing. I can't wait to see what 2020 will bring!

One of the benefits of being in the fishing industry is traveling to different places and hearing from other anglers. It never ceases to amaze me how many different applications of our products there are. We're always looking for new ways to improve our products or invent new ones, and our biggest asset is input from everyday angler. It has led to changes that make products like our planer boards perform even better. It has also led to new products as well as introducing us to new species to target like crappie and catfish. We're always happy to get input from fellow anglers; you can reach us on Facebook, by email, or by phone. We are also at various shows throughout the winter and spring. We have a great group of supporters and appreciate every one of you!

2019 couldn't have ended any better, with my dad and founder of Off Shore Tackle, Bruce DeShano, receiving his acceptance letter into the Freshwater Hall of Fame! I feel so blessed to be able to witness and be part of his journey from a maintenance man at Detroit Edison to a charter captain on Lake Huron, which led to the forming of Off Shore Tackle Co. LLC. His perseverance and dedication is what the "American dream" is all about.



ABOUT THE EDITOR

Mark Romanack is the long time editor of the Off Shore Tackle Release newspaper and also an Off Shore Tackle Pro Staffer. Mark began his outdoor writing career back in the late 80's when magazines and newspapers were the way information was shared with others. These days, Mark still writes for a few traditional outdoor publications, but most of his attention is focused on producing "digital" information in the form of outdoor TV, blogging, social media clips and YouTube video vignettes.

The Executive Producer for Fishing 411 TV which broadcasts on Sportsman Channel and also World Fishing Network, Mark has led this ship since 2007. Off Shore Tackle is the Title Sponsor for Fishing 411 TV.

When Mark is not producing educational materials for Off Shore Tackle and his other sponsors, he enjoys hunting with his family, shooting sporting clays and antique hunting for sporting collectables.

TROLLING LEAD CORE WITH THE OR12 SIDE PLANER

BY: MARK ROMANACK

Trolling with lead core line is one of the hottest presentations in the Great Lakes. While lead core is anything but new, a growing number of anglers are using this timeless presentation to target salmon, lake trout, brown trout, steel-head and even walleye.

ABOUT LEAD CORE

Lead core line is a sinking line that consists of a soft lead wire that is covered with a durable braided line sheath. Traditional lead core features a Dacron sheath, but modern lead core lines are covered in a more high-tech fiber known as Spectra. Spectra fiber lead core lines are thinner in diameter than those produced with a Dacron sheath and on average fish about 20% deeper per break strength.

Lead core line comes in a host of different break strengths including 12, 15, 18, 27, 36 and 45 pound test. Overwhelmingly the most popular sizes are 18 for walleye and 27 for trout and salmon fishing applications.

A growing number of anglers are favoring 27 pound test lead core and using it to target all the popular species. Spectra fiber lead core lines like Western Filament Micro-Lead have surfaced as the most practical option. Not only is this Spectra fiber lead core thinner and deeper running, it’s tougher and can be fished for several seasons before it needs to be replaced.

SEGMENTED LEAD CORE

The most practical way to fish lead core line is to rig it on a reel as a segment between a backing line and leader. The standard setup is 200 yards of backing line, tied to a pre-determined amount of lead core (1, 2, 3, 4, 5 color

etc.) then finished with a 50 foot length of fluorocarbon as a leader.

The lure, leader and all the lead core is deployed when fishing a segmented lead core rig. Lead core can be tied to backing line or leader material using a double uni knot. To make the knot as small as possible, remove about six inches of the soft lead wire from each end of the lead core before rigging lead core to backing line and leader material.

Backing line can be either monofilament or a super braid and is routinely 20 pound test. The fluorocarbon leader should be 15 pound test for smaller species like walleye and 20 pound test for larger species like trout and salmon.

BOARD RIGGING FOR BRAID BACKERS

Lead core line is most effective when married up to an in-line board like the iconic OR12 Side Planer. This popular planer board will handle up to 10 colors (300 feet) of lead core line.

When fishing a lead core setup that features a super braid backing line, the OR12 should be equipped with an OR18 Snapper Release on the bracket as well as an OR18 mounted to the tail of the board.

When the OR18 Snapper is rigged onto the bracket, the board will be permanently attached to the backing line. When a fish is hooked, the board and fish must be reeled in together. This rigging method is normally employed when just one or two lead core lines are fished per side of the boat.

BOARD RIGGING FOR MONOFILAMENT LINES

Segmented lead core line can also be rigged using a monofilament backing

line. Most anglers will favor a 20 pound test premium monofilament as the backing line.

When fishing this setup with an in-line board the OR12 Side Planer should be equipped with the standard factory setup of an OR19 (orange) line release on the bracket of the board and a red OR16 Pro Clip mounted at the tail of the board.

To setup this lead core rig let out the lure, leader and all of the lead core line until the monofilament backing line comes of the rod tip. Grab the line near the rod tip and place the line between the rubber pads of the OR19 release on the bracket. Next place the line between the rubber pads on the OR16 Pro Clip being careful to make sure the line is behind the plastic pin that protrudes through the center of the pads of this line clip.

Rigged in this manner the line can be tripped from the bracket release when a fish strikes, allowing the board to spin around in the water and also to stop planing. Meanwhile, the board remains pegged in place on the line thanks to the properly rigged OR16 Pro Clip.

This setup makes it possible to rig multiple lines per side of the boat without having to clear lines to reel in hooked fish.

STACKING LEAD CORE LINES

When fishing lead core lines it’s important to fish the shortest and most shallow running rigs as the outside board line. Progressively longer and deeper running rigs can be run as middle and ultimately the inside board lines. A typical six rod setup (check your local DNR regulations) would in-

clude a 5 color as the outside board line on both sides of the boat, a 7 color setup as the middle board on both sides of the boat and a 10 color setup as the inside board on both sides.

This setup does a good job of covering the water column from about 25 feet down to 50 feet down.

A WORD ON REELS

Lead core line takes up a lot of room on trolling reels and as a result larger reels must be employed. A typical 30 size level wind trolling reel will handle about 3 colors of lead core and adequate amounts of backing line. A 40 class reel will handle about 5 colors of lead core and sufficient backing line and a 50 class reel will handle either 7 or 10 colors of lead core and the required backing line.

Line counter style reels are not necessary for fishing lead core line as the angler is fishing a dedicated amount of line. The reel however should feature a faster line retrieve ratio to make it easier to reel in the long lengths of lead core that are typically needed to achieve significant depth. The Daiwa Saltist Level Wind reels feature a 6.4 to 1 retrieve ratio that is ideal for fishing lead core lines.

SUMMING IT UP

Lead core line is one of the most productive ways to target a host of Great Lakes species. Lead core is twice as deadly when married up to a quality in-line board like the OR12 Side Planer. Together lead core line and Off Shore Tackle boards are a team that can’t be beat.

TANGLE FREE

BY: JIM BRANDT

When I go out fishing, I like to be prepared with my poles ready to go with lures or baits on them that I will want to use that day. It does not matter if I am fun fishing or fishing in a tournament, I prepare the same way. When I am using crawler harnesses, I even have the OR36 Tadpole Divers or in-line weights and even bottom bouncers already on the rod with the harness I plan to use.

My rods sit upright in my rod holders when I am running from spot to spot. Just the other day I had two friends with me fishing for a day and we took off to where we wanted to start fishing, I told my friends to start getting crawlers on the rods.

One of these friends said to me "what are these on your tadpoles?" to which I replied, "rod butlers, so my lines will not be all tangled up." He told me that his lines are always tangled up from the wind and bouncing on the waves running to the next spot. Often people take simple things for granted, and I had always assumed my friends used this same method to prevent tangles.

Here is the step by step process that I use to avoid tangles. Using your OR36 Tadpole or in-line weight with a crawler harness on your rod, take the last hook of the crawler harness and hook it into the hook keeper or the first guide from the reel. If your crawler harness is long, like the ones that I prefer to use, take the last hook and put it into the handle above the reel. Once I have the hook set into the rod, tighten up the line until it is good and tight. Take the rod butler and slide it over the end of the rod and over the top of the Tadpole until it is on the thinner side of the Tadpole.

Once it is in place, cinch the rod butler down tight to your rod. After this has all been completed, everything will be held fast and the line will not be able to flop in the wind or tangle with other rods. If you are using in-line weights do the same steps, except put the rod butler by the front eyelet of the weight. For the times when I use a bottom bouncer I take the hook harness just the same as was explained earlier, but I take one hand and squeeze the wire on the bouncer close



Using bungee cords to secure Tadpole Divers to the road helps to eliminate tangles and makes for a more productive day on the water.

to the rod and slide the rod butler around the rod and the two wires above the weight and cinch it down tight.

Some of you may be wondering if the weight against the rod will damage the blank or even possibly break your rod, and I want you to know that the 15 years or more that I have used this method I have never had a rod damaged yet. The key to this method is to have everything on your rod tight so there can’t be any movement in your line or weight. I hope you have found these tips helpful and that this will keep your lines from tangling on your next fishing trip.

DON’T BE FOOLED

We are “Often Imitated, Never Duplicated”. Make sure that when you purchase your products that they are Original Off Shore Tackle and Riviera products that have proven to be successful and dependable! We take pride in bringing you the BEST quality!